



4/15 Gladstone Street Bexley, NSW 3 2 2

An expansive apartment with sunlit living areas

Buyers who demand impressive space and privacy will be instantly attracted to the super-large proportions and peaceful setting of this oversized top floor residence in a small, boutique block of only 4 units. Offering over 175sqm of total space on title, it offers an expansive retreat that is light filled throughout and set up high to capture an elevated district aspect. Perfect for those who value house-sized proportions yet appreciate the low-maintenance lifestyle that comes with apartment living, it delivers the ideal package and is set within walking distance to Rockdale station, Seaforth Park, shopping amenities and local schools.

Price: SOLD \$1,130,000 | Ray Fadel



Ray Fadel
0413 177 739



Jordan D'Amato
0408 031 109

4/15 Gladstone Street
Bexley

STONE

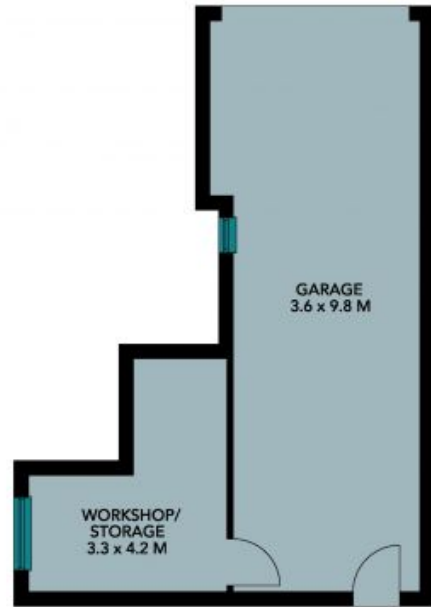

(NOT IN POSITION)



The floor plan is not to scale, measurements are indicative and in metres, exterior elements are not in position. Plans should not be relied on, interested parties should make and rely on their own enquiries. All other information provided has been collected from reliable sources but cannot be guaranteed for accuracy.

4/15 Gladstone Street
Bexley

STONE



The floor plan is not to scale; measurements are indicative and in metres. All features included in this 3D plan are for inspiration purposes only. This is not an exact replica of the property or the position of exterior elements. Plans should not be relied on. Interested parties should make and rely on their own enquiries.