

STONE



1002/1-3 Raglan Street Manly, NSW

3 

2 

2 

Oceanfront luxury with showstopping panoramic views

Unquestionably one of Manly's finest luxury residences, this superb approx 217 sqm sub-penthouse security apartment occupying the prized north-eastern corner of the building boasts an enviable setting directly opposite world famous Manly beach. The jewel in the crown of this incredible home is an expansive wraparound rooftop terrace showcasing spectacular ocean and coastal panoramas sweeping from Long Reef, along Queenscliff, Manly and Shelly Beaches, across exclusive Eastern Hill and over Manly Cove to take in the twinkling lights of the Sydney city skyline.

- Huge beachfront terrace with custom bbq station, including built-in marine-grade stainless steel bbq and integrated cooler boxes
- Rooftop terraces wraps around entire apartment with prized northern and eastern aspect
- Granite kitchen with Miele appliances including integrated dishwasher and coffee-maker
- Deluxe master suite with walk-in robe, generous ensuite and sliding door access directly onto entertaining terrace

Price:

Contact Agent



Jessica Fedrigo

0404 989 070



Julian Rowe

0412 544 448

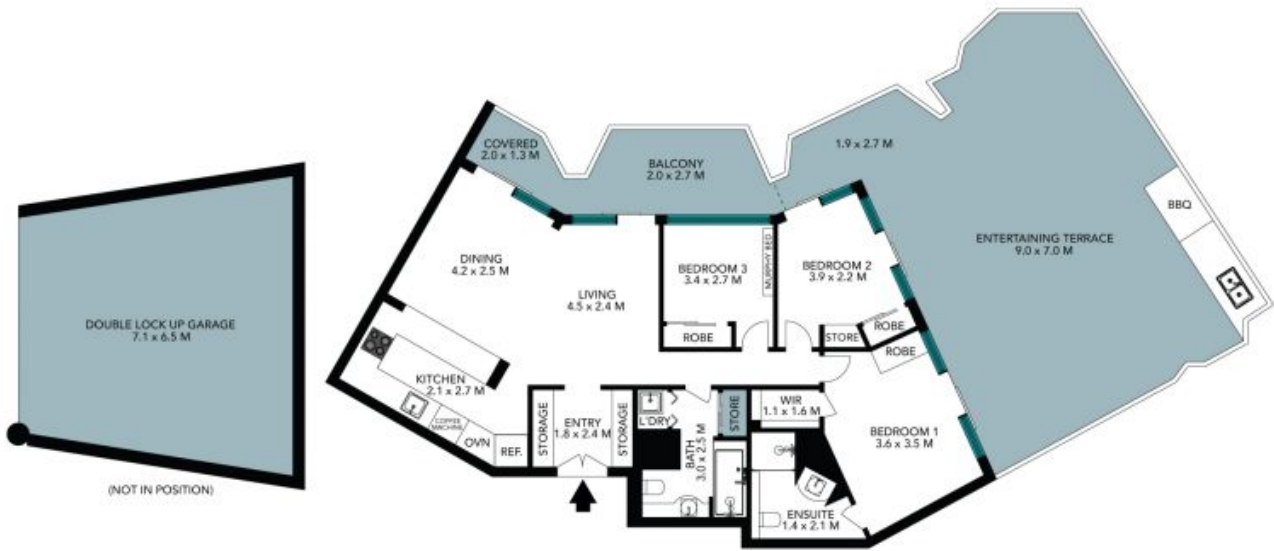

The floor plan is not to scale, measurements are indicative and in metres. Certain elements are not in position. Plans should not be relied on. Interested parties should make and rely on their own enquiries. All other information provided has been collected from reliable sources but cannot be guaranteed for accuracy.

1002/1-3 Raglan St
Manly



The floor plan is not to scale; measurements are indicative and in metres. All features included in this 3D plan are for inspiration purposes only. This is not an exact replica of the property or the position of exterior elements. Plans should not be relied on. Interested parties should make and rely on their own enquiries.