



20A Musgrave Street MOSMAN, NSW

5  3  2 

SOLD

More like a resort, this architect designed, contemporary 4-5 bedroom home is set on a large parcel of over 840 square metres of waterfront land, with its own deep water pontoon fronting onto Mosman Bay.

Cleverly designed to take in the amazing views, sunlight and breeze

Generous open plan dining and living areas make entertaining a breeze

Wonderful country-style eat in kitchen

The master bedroom suite is of grand proportions and opens to a private oversized deck overlooking the sparkling waters of Mosman Bay. This master suite is a haven of tranquillity with its decadent ensuite bathroom and own private study

Designed to capture natural sunlight, this low maintenance home feels more like a luxury resort

Large wine cellar and workshop

Inclinators from the double carport to the front door

Council rates \$884pq approx Water rates \$275pq

With breathtaking harbour views, life doesn't get any better!



Ivan Resnekov

0411 500 240

20A MUSGRAVE STREET MOSMAN

LOWER LEVEL



UPPER LEVEL



BASEMENT

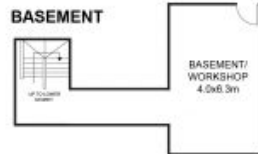

SITE PLAN



Scale in metres. Measurements are approximated only. All information contained herein is obtained from sources we believe to be accurate. We cannot guarantee its accuracy. Interested persons should make and rely on their own enquiries.

