



1/814 Military Road MOSMAN, NSW 3  2  2

### Low Maintenance Garden Paradise

Boasting a large 280sqm of living area, this three bedroom garden apartment is at the pinnacle of design, build quality and appointment. With its sun-drenched level lawn and undercover terrace, this home is ideal for entertaining. Youll fall in love with the seamless transition from its open plan flowing interiors to its low maintenance garden, an address that sets an unequivocal benchmark for style and convenience!

Stone Real Estate -  
Head Office



# Thirri Tyirri

A lifestyle without compromise

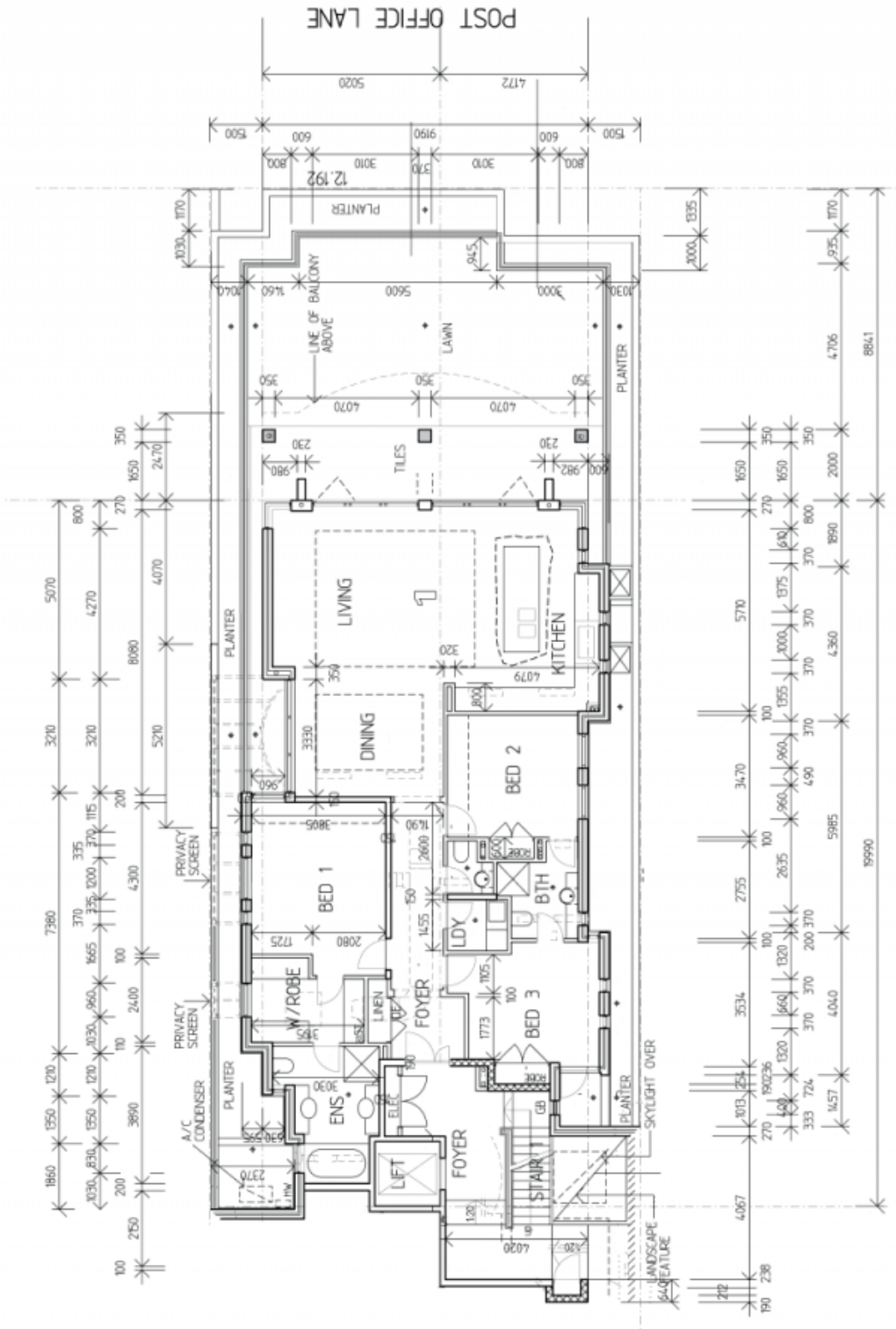

>>Residence 1 - Ground Floor - 313 sqm (approx)