

2/814 Military Road MOSMAN, NSW

3 2 2

Brand New Luxury Apartment in Boutique Building

This first floor residence offers over 200sqm. of indulgent interiors centred around an open plan lounge and dining room opening to a wide terrace balcony with perimeter garden. The stylish Caesar stone kitchen with breakfast bar overlooks the main living areas, ideal for entertaining with friends while three double bedrooms with balconies offer sumptuous accommodation including ensuite bathrooms.

Stone Real Estate -
Head Office



Thirri Tyirri

A lifestyle without compromise

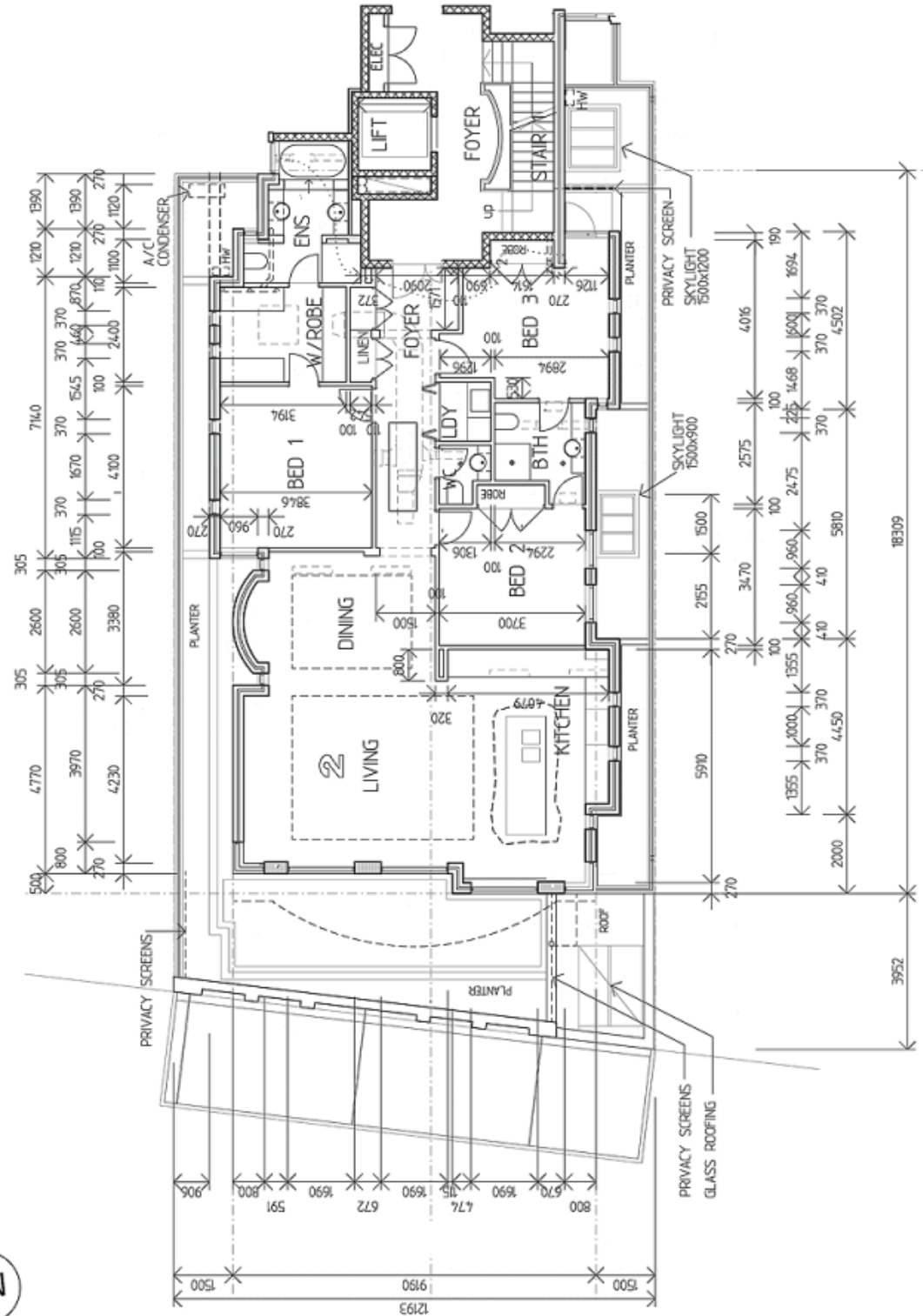

>>Residence 2 - Level 1 - 239 sqm (approx)