

43A Shadforth Street MOSMAN, NSW

3 

1 

1 

### Gorgeous Sundrenched Semi

Set on the sunny side of this quiet street, this exceptional semi-detached cottage has been thoughtfully extended to maximise family living and entertaining space.



Ivan Resnekov

0411 500 240

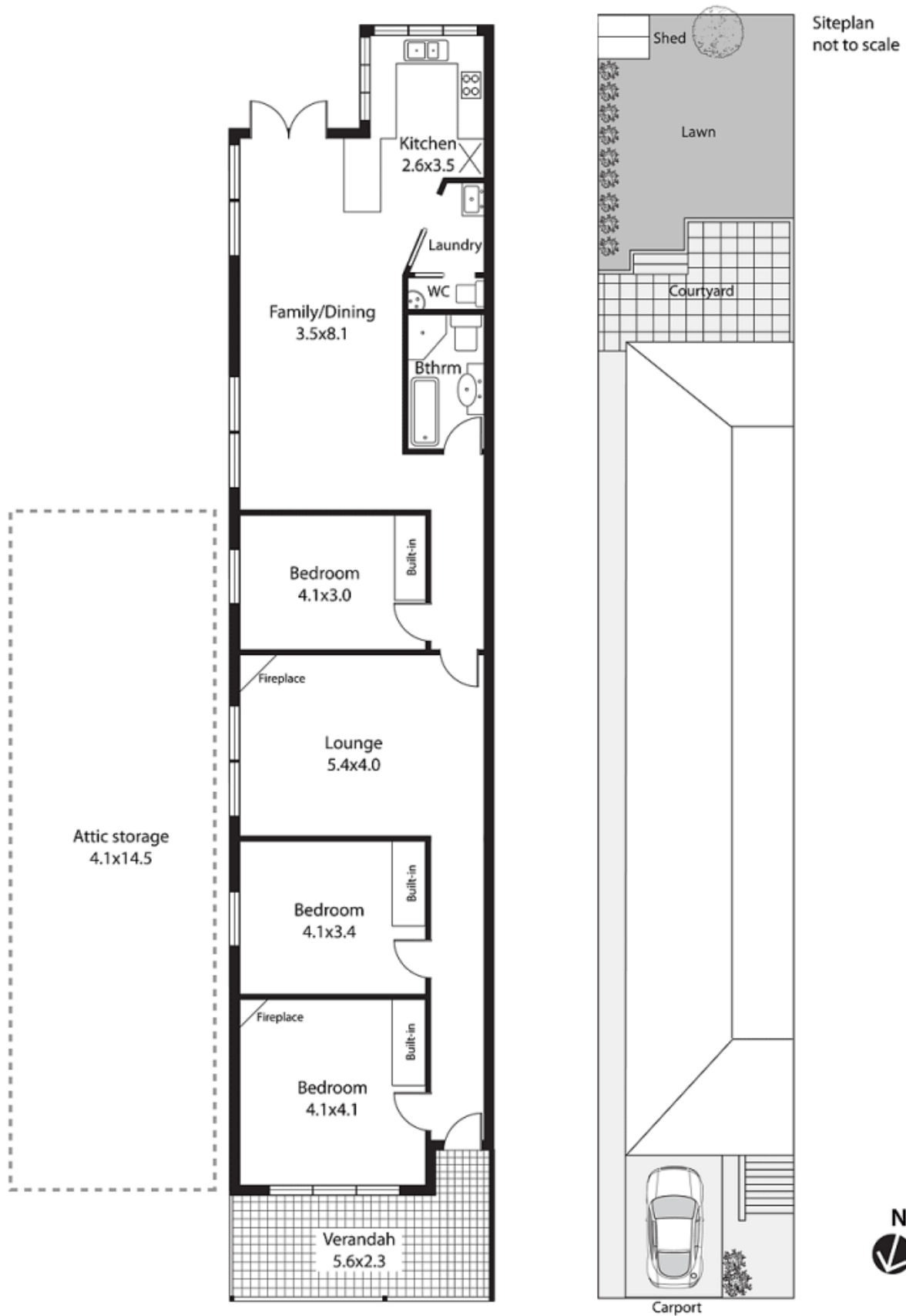

## 43A Shadforth Street Mosman

Plans are for presentation purposes only and are not part of any legal document or title and should not be used as a sole reference. Interested parties should make their own enquiries using other sources. Measurements are approximates. ©2012 Century 21 Resnekov Realty We do not guarantee or give any warranty as to the accuracy provided. Interested parties must rely on their own inquiries.