

302/56 Spit Road MOSMAN, NSW



Stylish Luxury Apartment. Excellent Investment

An inspired split level design configured for modern living in a convenient location! This contemporary top floor one bedroom apartment is located on the quiet side of the block and offers district views plus water glimpse. The property includes security parking and convenience to Mosman Village and Balmoral.

- * Large combined lounge and dining opening to full width balcony
- * Elevated double bedroom with full length built-in on one wall
- * Galley kitchen, large main bathroom with marble vanity plus internal laundry
- * Dedicated study area, air conditioning, video intercom, lift access
- * Level walk to shops/buses or 2 minute drive to Balmoral

Price:

Auction



Ivan Resnekov

0411 500 240

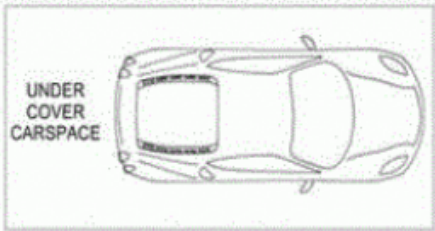
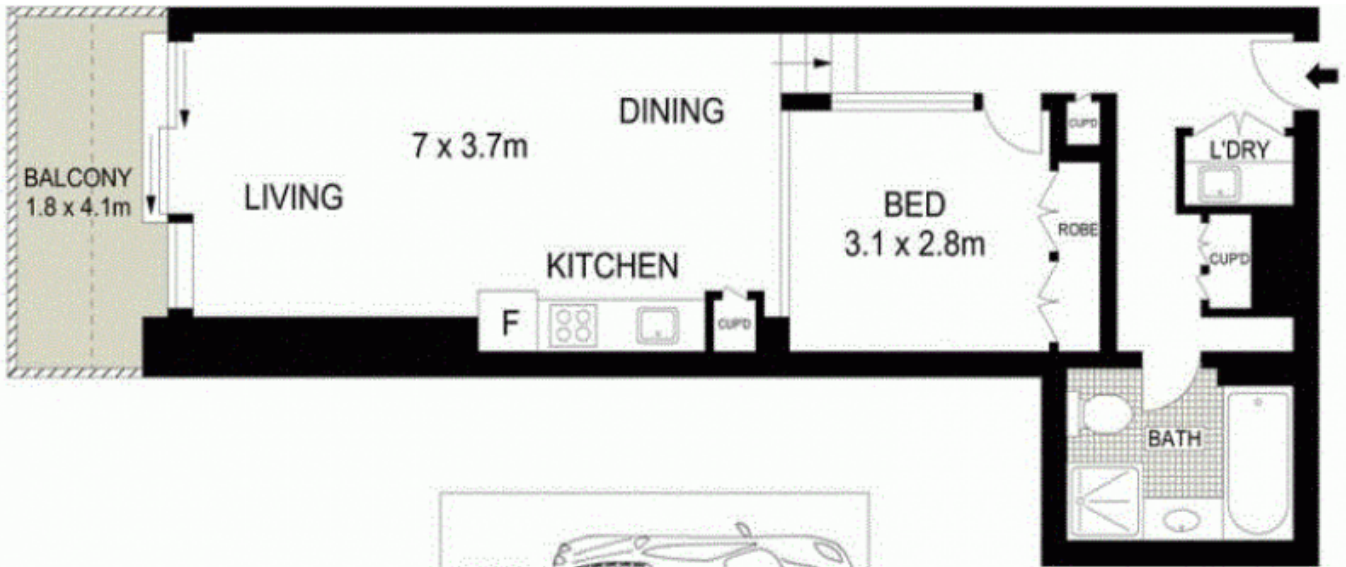

GROUND FLOOR



Scale in metres. Indicative only. Dimensions are approximate. All information contained herein is gathered from sources we believe to be reliable. However we cannot guarantee its accuracy and interested persons should rely on their own enquiries.

302/35 Spit Road, Mosman

