

3/13-17 Greek Street GLEBE, NSW 1 1

Convenience, location & lifestyle

Offering an outstanding lifestyle opportunity for first home buyers or investors, this ultra-convenient one bedroom security apartment with 55sqm of living is literally moments to Broadway Shopping centre, UTS, Sydney University, CBD, public transport and Glebe Point Road eateries.

- Spacious open-plan living and dining with timber laminate floorboards
- Gourmet gas-cooking kitchen equipped with granite bench tops & stainless steel appliances
- Good sized bedroom with a large built-in wardrobe
- Reverse-cycle air-conditioning, under-cover balcony
- Modern stylish bathroom with bath and an Internal laundry
- Only minutes walk to Victoria Park, Wentworth park, buses, Central Station, cafes and restaurants

Council rates: \$237.40 pq (approx)
Water rates: \$166.00 pq (approx)
Strata levies: \$805.00 pq (approx)

Price: RECENT SALES



Andrew Thomas

0421 281 234

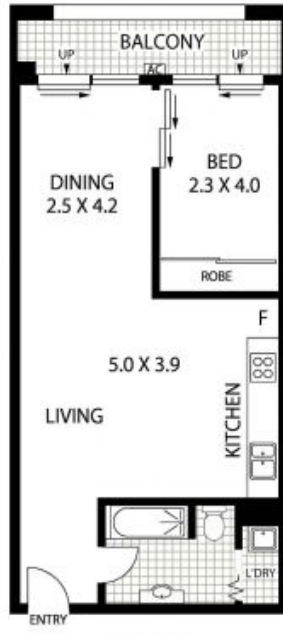

FIRST FLOOR



3/13-17 GREEK STREET

GLEBE

Please Plan Ahead! - Read the Caping floor plan / site plan as intended or approximate guide only. No representations or warranties of any nature are given or intended and any parties using this information plan their own guide. Always check on their own enquiries. Mod for Cap property marketing services / 1800 100 100 / Photography, Floorplans, Copywriting, Sales, Online, Design / www.modforcap.com.au