



2/26 Brierly Street CREMORNE, NSW

2 1 1

UNDER CONTRACT

Full of character, spacious 2 bedroom plus study/dining ground floor apartment in a small 1920's block of only 6 (2 per floor). Large bedrooms, main with with built-ins, separate lounge/dining, internal laundry, modern kitchen. Centrally located with just moments to city transport and Spofforth Street shops. This property is situated on the border of Cremorne & Mosman, on the Mosman side.

Stone Real Estate -
Head Office

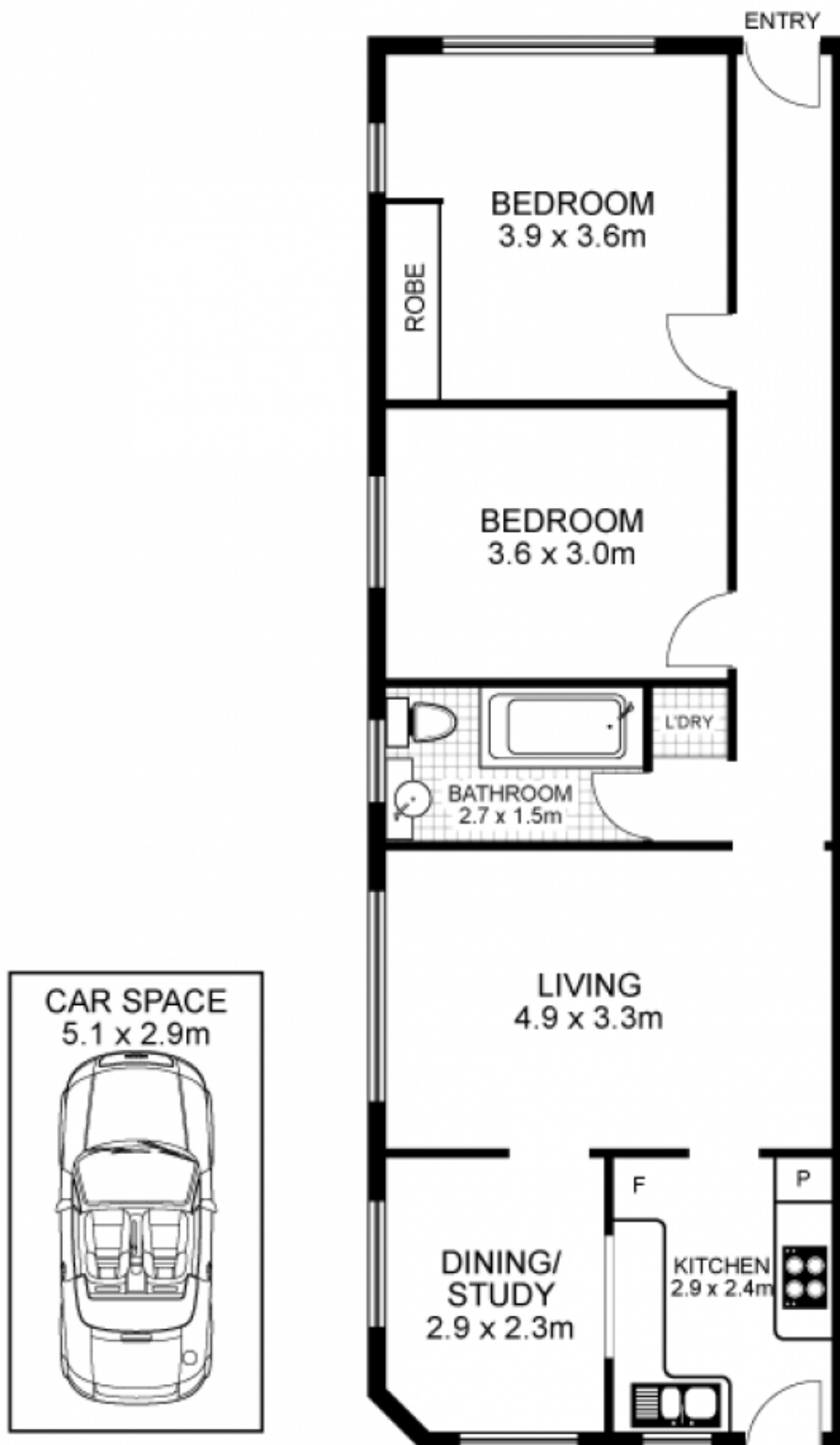

2/26 Brierley Street, MOSMAN

Disclaimer: This floor plan is intended as a guide only. Layout dimensions are approximate only. No representations or warranties of any nature whatsoever are given or intended. Any individuals using this information should always rely on their own enquiries.

www.alchemyimaging.com.au