



53 Belgrave Street CREMORNE, NSW

2 

1 

2 

Unlock the Potential

Take advantage of this exciting and rare opportunity to acquire an attractive sandstone semi on a generous 340sqm parcel of land. Situated perfectly for convenient everyday living, minutes from the heart of Neutral Bay's vibrant restaurant scene & with shops conveniently close by, plus transport at your door. The property offers scope for improvement and benefits from rear lane access to a huge double lock up garage with storage.

Stone Real Estate -

Head Office

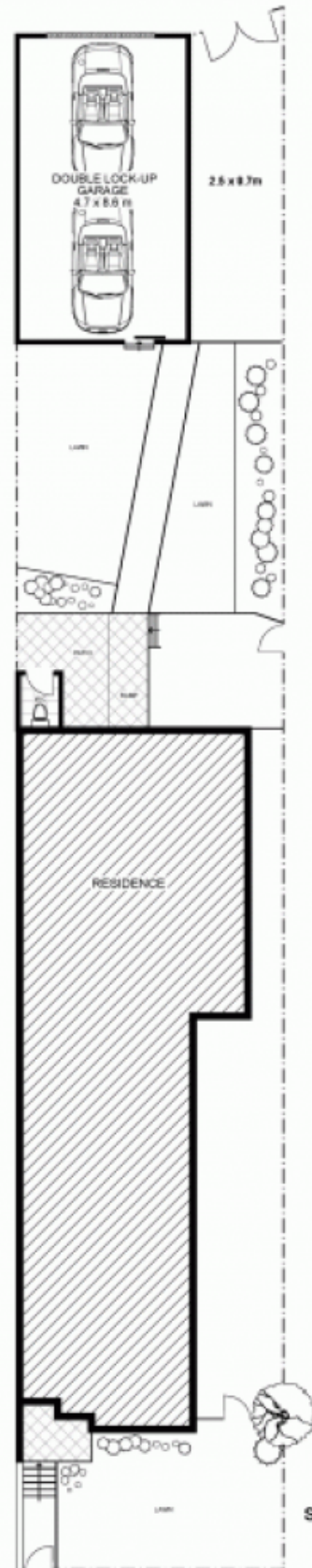
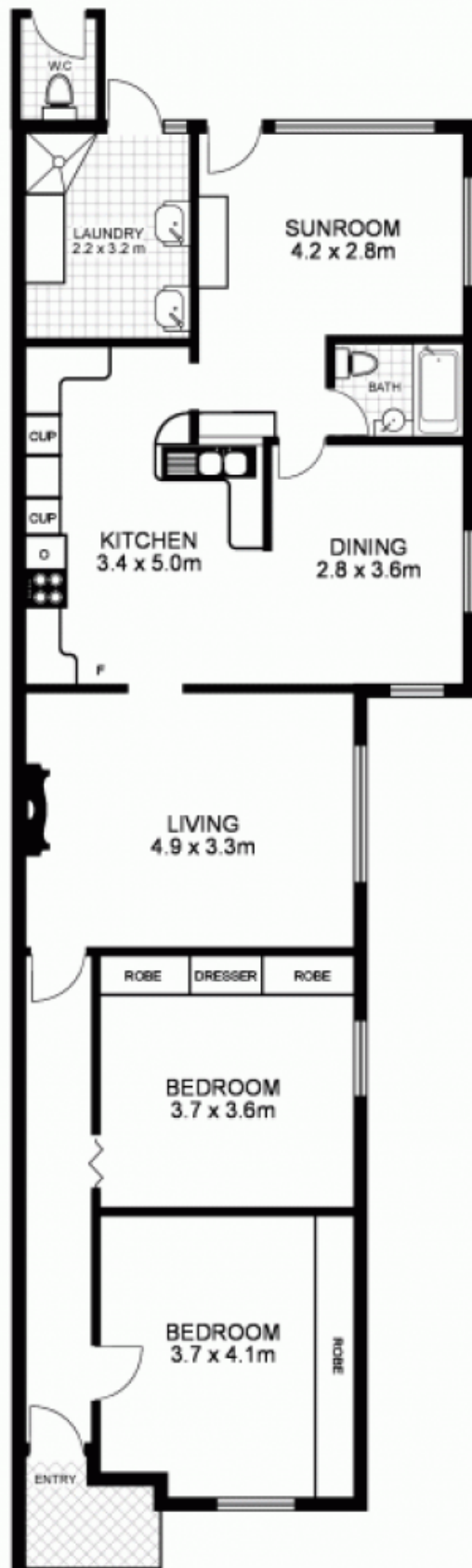

53 Belgrave Street, CREMORNE

Disclaimer: This floor plan is intended as a guide only. Layout dimensions are approximate only. No representations or warranties of any nature whatsoever are given or intended. Any individuals using this information should always rely on their own enquiries.

www.alchemyimaging.com.au