



10/94-96 Alfred Street MILSONS POINT, NSW 2 1 1

### Ultimate Executive Apartment

This luxurious executive apartment is perfectly located opposite Milsons Point station offering the most convenient transport to Sydney CBD, or just stroll across the harbour bridge which is on your doorstep. Kirribilli cafe's, shops, restaurants, North Sydney pool & gym and Lavender Bay parks are also just moments away.

**Price:** Offers over \$750,000

**Stone Real Estate -  
Head Office**

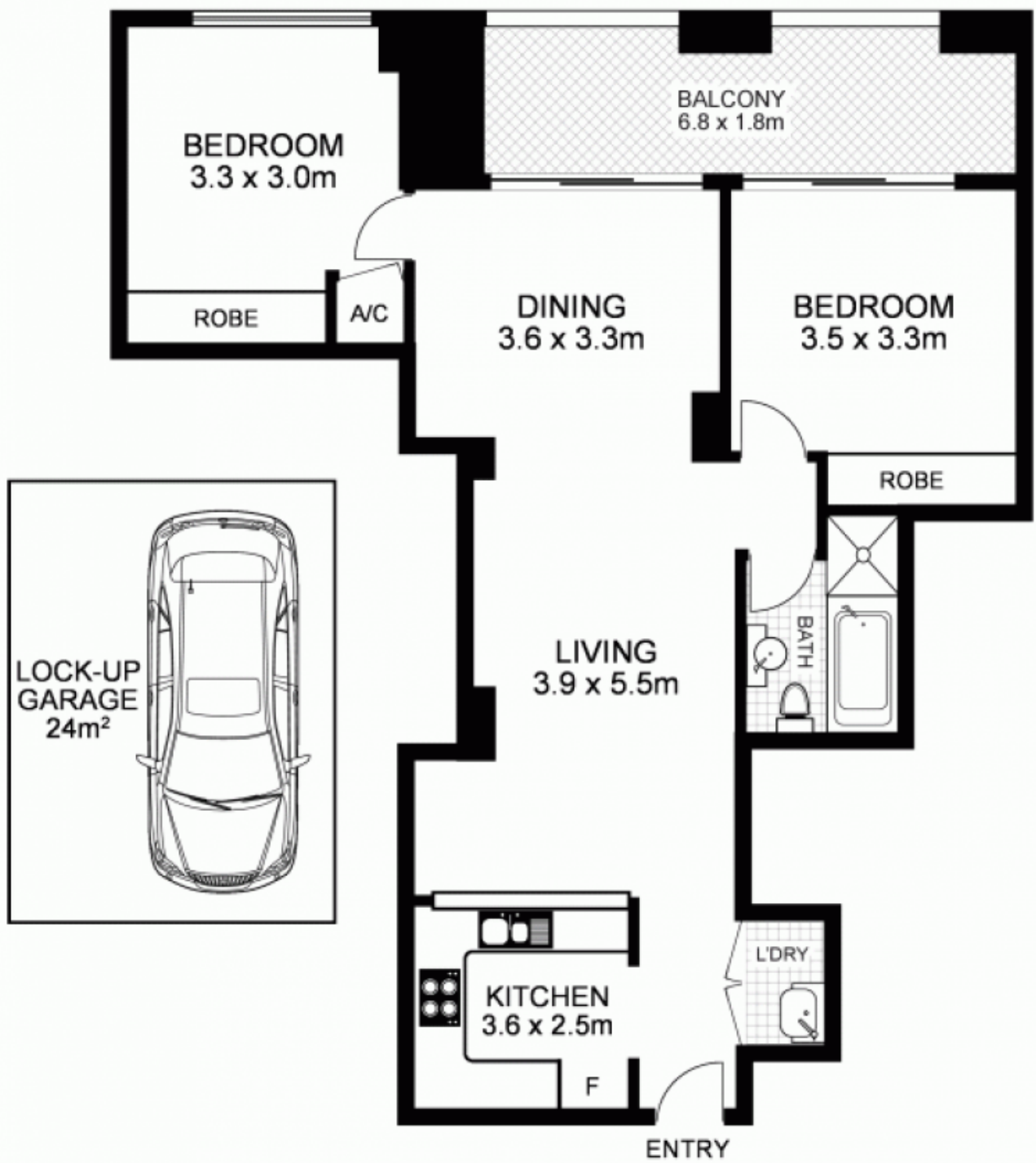

**10/94-98 Alfred Street, MILSONS POINT**

Disclaimer: This floor plan is intended as a guide only. Layout dimensions are approximate only. No representations or warranties of any nature whatsoever are given or intended. Any individuals using this information should always rely on their own enquiries.  
[www.alchemyimaging.com.au](http://www.alchemyimaging.com.au)