



6A/74 Prince Street MOSMAN, NSW 2 1 1

Position, Privacy & Panoramic Views

This apartment has everything on your wish list. Ideally positioned, on the North/East corner of the building on level 6, the whole property is filled with natural light & sunshine and captures stunning, unobstructed district views for as far as the eye can see. Excellent living area of over 85sqm with undercover parking and a separate lock up storage. Centrally located just a short walk away from Cremorne junction and a level walk to Mosman village with nearby cafes, restaurants, shops, Orpheum cinema and easy transport to Sydney CBD.

Price: For Sale \$950,000 - \$975,000

**Stone Real Estate -
Head Office**

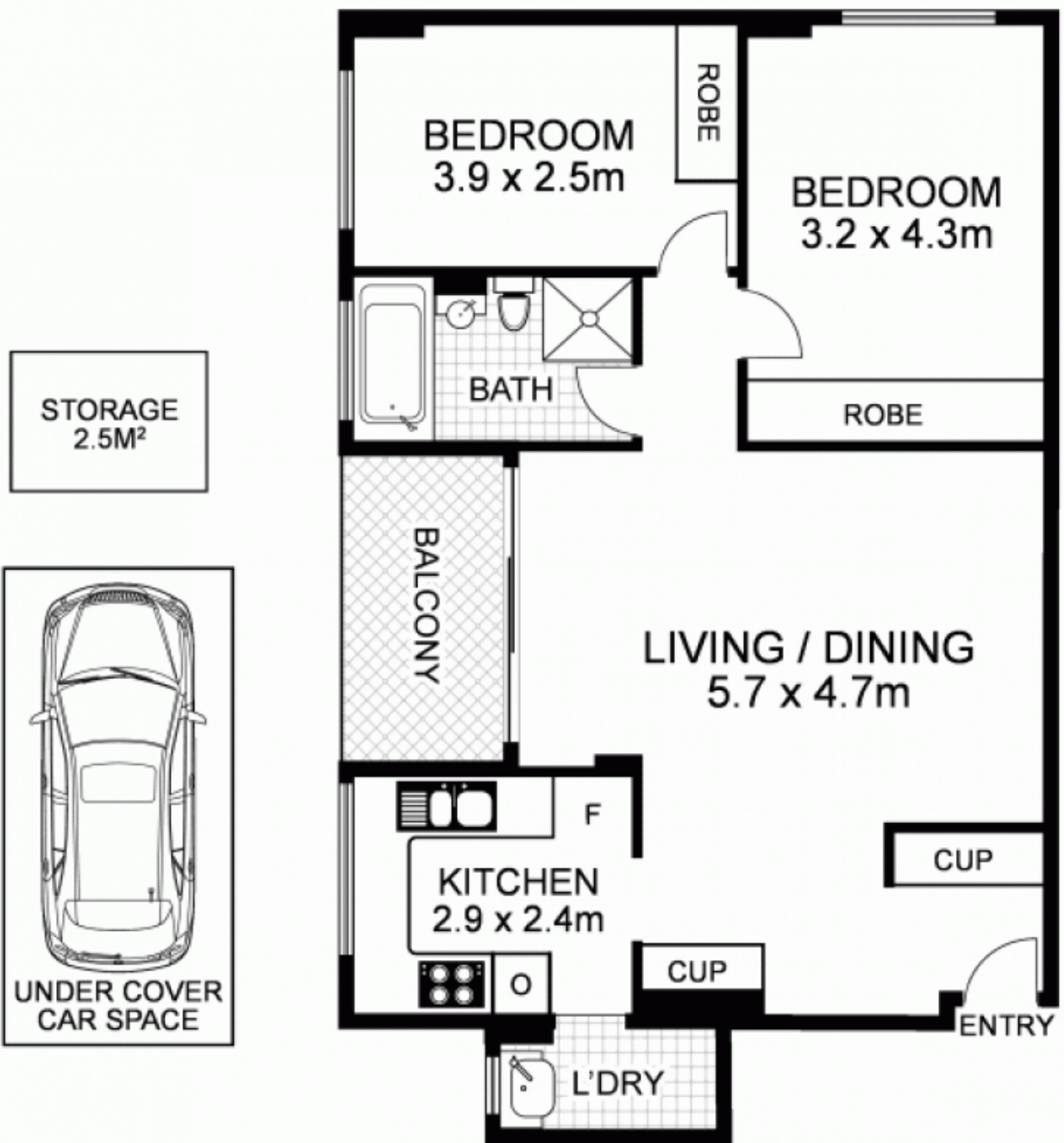

NORTH

6a/74 Prince Street, MOSMAN

Disclaimer: This floor plan is intended as a guide only. Layout dimensions are approximate only. No representations or warranties of any nature whatsoever are given or intended. Any individuals using this information should always rely on their own enquiries.



first national
REAL ESTATE | Cremorne

THINKING OF SELLING?

Why not call us for a free market appraisal of your property?

2a/283 Military Road
Cremorne

cremornefn.com.au

9904 1234