



29 Patricia Street Marsfield, NSW

4 2 6

Ultimate Family Home in Blue Ribbon Street

Located in one of the most sought-after streets in Marsfield this large full brick home is perfect for a growing family or astute investor. Exceptionally built the home offers family practicality and comfort throughout its multiple, indoor & outdoor living areas whilst offering even further scope to further capitalize by adding a pool, granny flat, extending or rebuilding (STCA).

Price: For Sale - Contact Agent
Council Rates: \$360.00 p/q
Water Rates: \$158.45 p/q



James Sarzano

0410 155 496



Jason Segon

0435 606 398

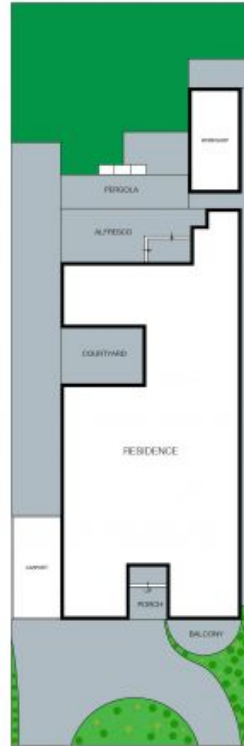

INTERNAL AREA: 283 SQM
 TOTAL AREA: 796.7 SQM

The floor plan is not to scale, measurements are indicative and in metres. Detail elements are not in position. Plans should not be relied on. Interested parties should make and rely on their own enquiries.

29 Patricia Street, Marsfield

