



26 Terrace Road Killara, NSW



SOLD BY RYAN WOO & ROSANNA MORLEY

Generous Family Living with Exceptional Landholding and Future Potential



Ryan Woo

0410 884 680



Rosanna Morley

0413 053 322

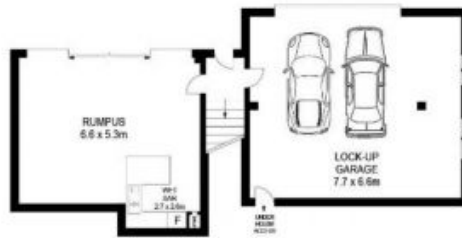

LOWER GROUND FLOOR



GROUND FLOOR



INTERNAL FLOOR AREA: 214 SQM APPROX

26 Terrace Road Killara

Disclaimer: This floor plan is for presentation purposes only and is not part of any legal document or title. It may contain errors, omissions, or inaccuracies and should not be relied upon as an exact representation. Interested parties are encouraged to conduct their own inquiries using independent sources.