



5/101a Faunce Street West Gosford, NSW

2 2 1

Convenient Location

Positioned within walking distance to Gosford Railway Station and CBD, this spacious townhouse offers a sunny north facing aspect. This property consists of:

- Master bedroom with walk in wardrobe and balcony access.
- Second bedroom with built in wardrobe.
- Good size lounge room with balcony access and air conditioning.
- Neat kitchen with electric cooking.
- Shower over bath tub.
- Lock up garage with internal access and internal laundry.

Water Rates- \$912.89 per year
 Council Rates- \$1,110.62 per year
 Strata Levies - \$760.85 per quarter

Price: \$532,000
Council Rates: \$1,110.62/year (approx)
Water Rates: \$912.89/year (approx)



Adrian Knight
 0410 407 188

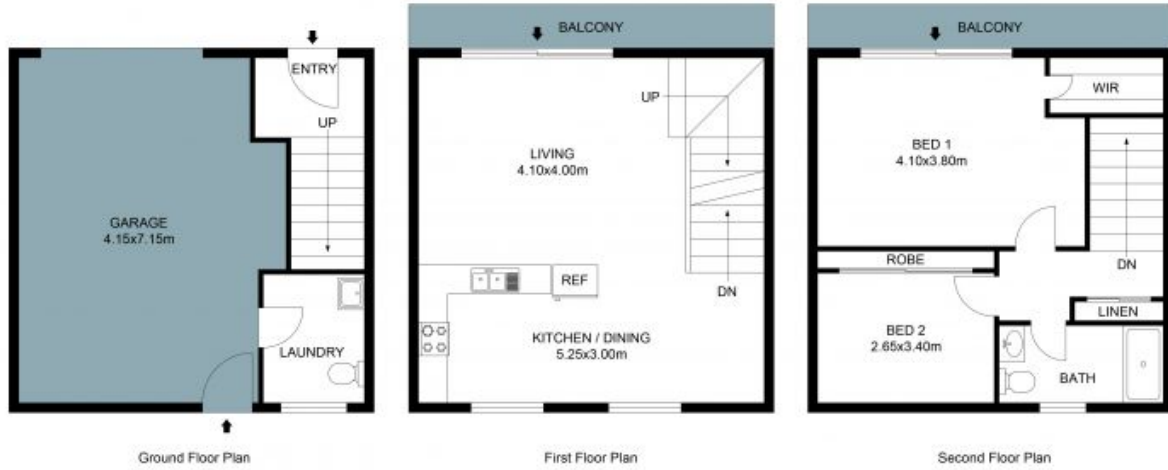

The Floor plan is not to scale; measurements are indicative and in metres. Plans should not be relied on. Interested parties should make and rely on their own enquiries. All other information provided has been collected from reliable sources but cannot be guaranteed for accuracy.