



454 Jamberoo Mountain Road Jamberoo, NSW

3 

2 

4 

SOLD BY STONE REAL ESTATE | DARNELL HASELAU & GREG CRUMPTON

Price:

\$1,620,000

Large homestead positioned on picturesque rural land



Darnell Haselau

0426 400 240



Greg Crumpton

0418 557 185

454 Jamberoo Mountain Road
Jamberoo

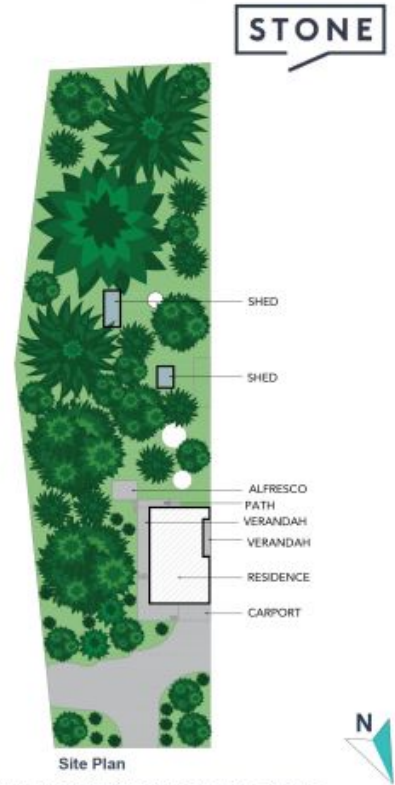
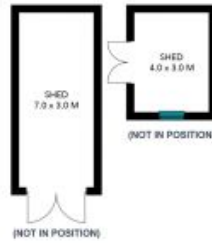

The site plan and floor plan are not to scale; measurements are indicative and in metres. Bushes and trees are placed for illustration purposes. Plans should not be relied on. Interested parties should make and rely on their own enquiries. All other information provided has been collected from reliable sources but cannot be guaranteed for accuracy.