



13 Suffolk Close Coffs Harbour, NSW

5  2  2 

"Beautifully built family home!!"

Designed to optimise the stunning scenic northerly mountain views. This immaculate 5 bedroom master built home blends quality inclusions with contemporary style. It delivers supreme privacy and enjoys a serene cul-de-sac setting.

Price: \$859,000-\$879,000

Council Rates: \$2,861.00 p/q



Yvette Ward

0403 602 544

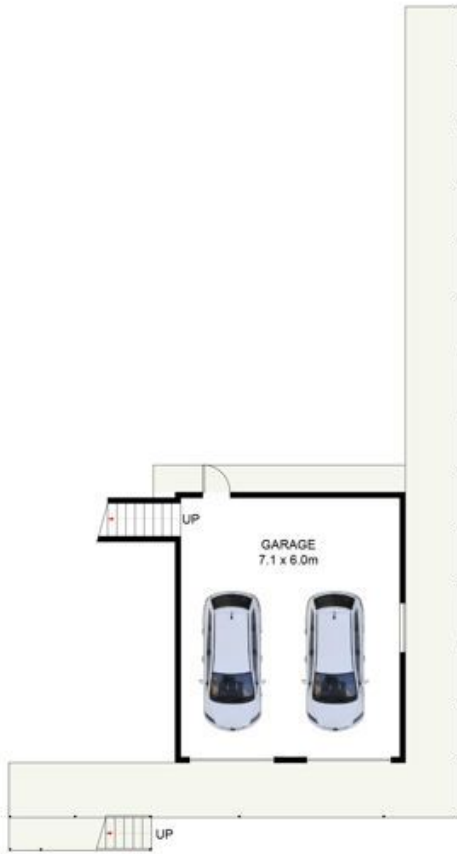

GROUND FLOOR



FIRST FLOOR

florent & munday



13 Suffolk Close, Coffs Harbour NSW 2450

DISCLAIMER: PLANS SHOWN ARE FOR PRESENTATION PURPOSES AND ARE NOT PART OF ANY LEGAL DOCUMENT. ALL MEASUREMENTS AND FIGURES ARE APPROXIMATE.