



35 Lady Belmore Drive Boambee East, NSW

4  2  2 

"Fabulous Family Home"

Rates \$3032pa approx.

Price: \$829,000
Council Rates: \$3,032.00 p/q



Yvette Ward

0403 602 544

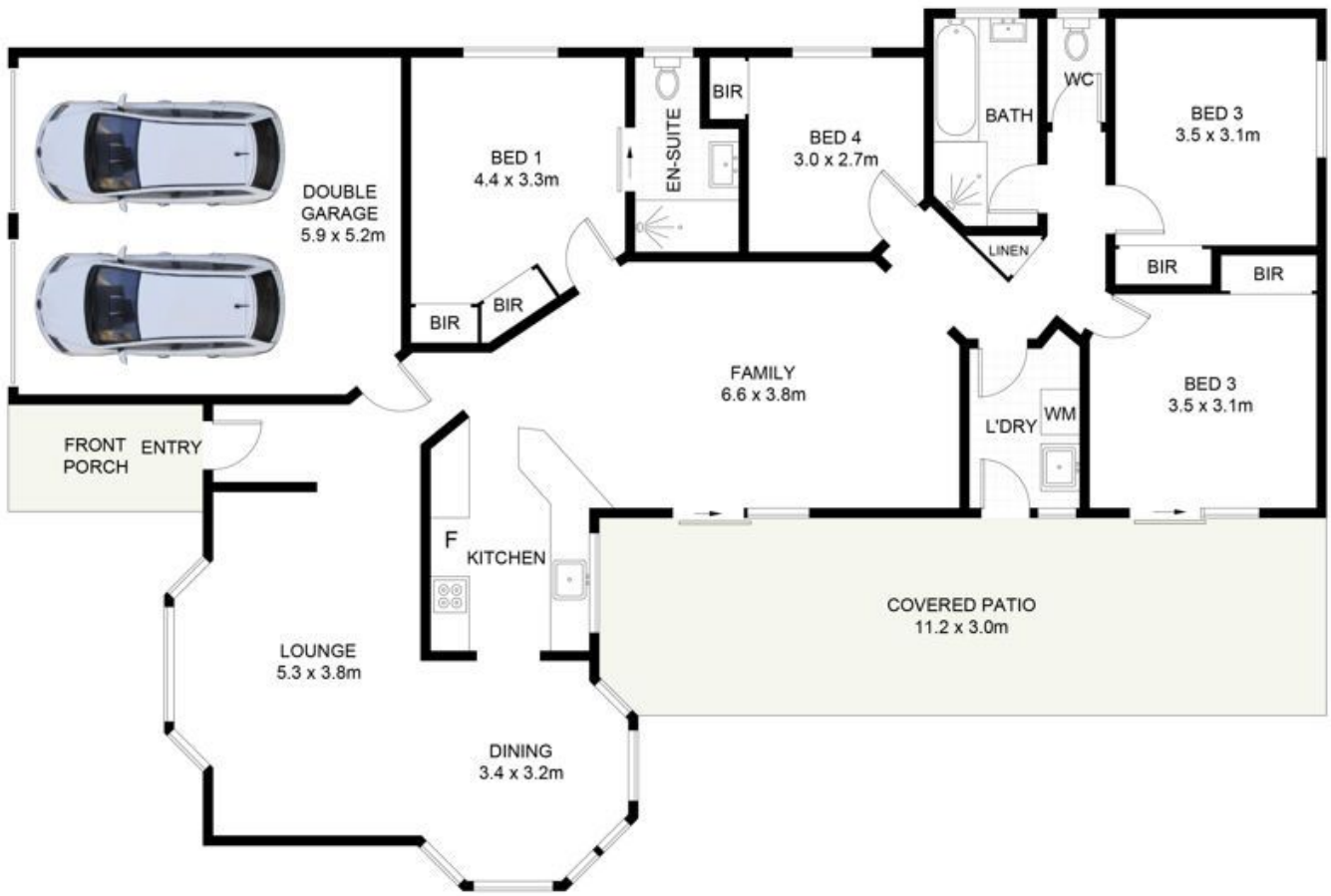

florent & munday



35 Belmore Drive, Boambee East, NSW 2452

DISCLAIMER: PLANS SHOWN ARE FOR PRESENTATION PURPOSES AND ARE NOT PART OF ANY LEGAL DOCUMENT. ALL MEASUREMENTS AND FIGURES ARE APPROXIMATE.