



199 McAlpine Way BOAMBEE, NSW



"Beautiful 1.5 acres in Middle Boambee"

Occupying an idyllic 6,000m² of stunning lawns & gardens this beautiful family home is perfectly presented and offers enviable semi rural living in the Boambee valley. Thoughtfully designed the home features 4 bedrooms, 2 bathrooms, 2 living areas & 2 Kitchens, ideal for families seeking self contained living for teenagers or inlaws. You'll love entertaining on the huge north/east facing deck which overlooks the yard and is accessed from both the lounge & master bedroom. Complete with an oversize double garage plus 2nd entertaining area with spa this beautiful property is ready for its new owner to move straight in.

Price:

\$669,000

Stone Real Estate -

Head Office

199 McAlpine Way, Boambee

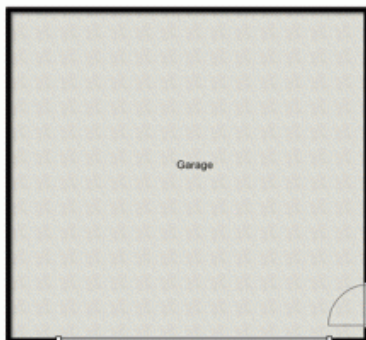

florent & munday

Whilst every attempt has been made to ensure the accuracy of the floor plan contained here, measurements of doors, windows, rooms and any other items are approximate and no responsibility is taken for any error, omission, or mis-statement. This plan is for illustrative purposes only and should be used as such by any prospective buyer.

www.rocketshots.com.au