



35 Canale Drive BOAMBEE, NSW

4

2

5

### "Boambee Beauty"

The moment you walk through the door you immediately feel at home! This immaculate 4 bedroom home is level yet elevated to catch the beautiful sea breezes & mountain vistas.

**Price:** \$830,000

**Stone Real Estate -**

**Head Office**

NOTE: ALL TIMBER FRAMING AND SUPPORT MEMBERS TO A.S. 1884 TIMBER FRAMING CODE

NOTE: INWARD SWINGING DOORS TO V.C. AND ENSUITE TO BE FITTED WITH REMOVABLE HINGES

SHOWER NOTE: PLACE TAPS VERTICALLY WITH NOZZLE & TAPS POSITIONED AS SHOWN

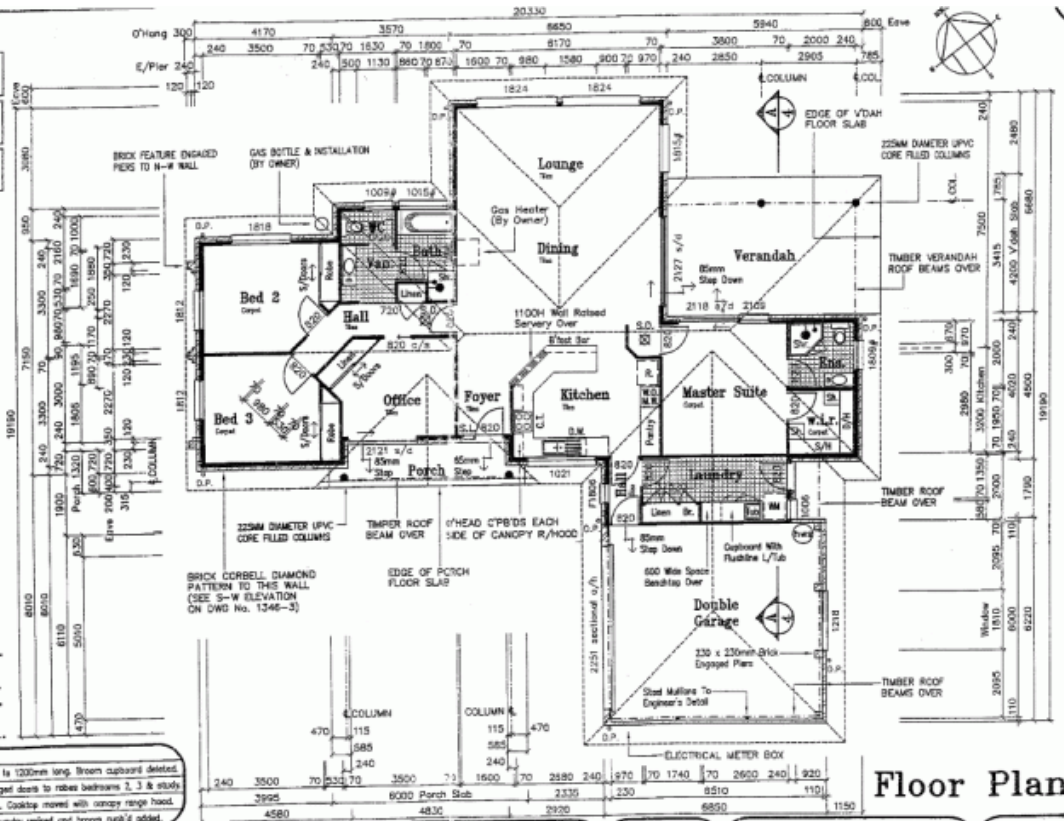

**Floor Areas:**  
 Living: 167.60 sq.m.  
 Verandah: 27.47 sq.m.  
 Garage: 41.95 sq.m.  
 Porch: 7.08 sq.m.  
**Total: 244.10 sq.m.**

No.	Date	Description
A	16/10/03	Bedrooms vanity increased to 1200mm long. Screen cupboard deleted.
		Sliding doors in lieu of hinged doors to robes bedrooms 2, 3 & study.
		Hall oven & M.N. reinstalled. Cooktop moved with canopy range hood.
		N.C. to laundry deleted. Laundry revised and broom cupboard added.

### Floor Plan

#### COPYRIGHT

Plans & designs including the intellectual & confidential information contained herein are the property of Blue Ribbon Designs & are not to be reproduced or applied in whole or in part or used for unauthorised manufacturing or any other application of the items depicted herein or in any way disclosed or used for anything other than the person or persons to whom they are exclusively the copyright of Blue Ribbon Designs.

### Blue Ribbon Designs HOME DESIGNERS

WINNERS OF 3 "EXCELLENCE IN HOUSING" AWARDS  
 2/22 Meares Street  
 COFFS HARBOUR, N.S.W. 2450  
 Phone: (02) 6651 8144

Scale: 1:100  
 Date: AUG '03  
 Drawn: G.BULL  
 Checked: B.L.E.

Drawing Details  
 PROPOSED RESIDENCE AT  
 LOT 11 CANALE DRIVE  
 MIDDLE BOAMBEE FOR  
 P. ORR & K. BRAZEL

Drawing No.  
 1346-2 A  
 SHEET 2 OF 5