



1 Kintorie Crescent TOORMINA, NSW 3 1 2

### "Family Home In A Great Location"

This lovely 3 bedroom home is immaculate throughout and features lounge room with air conditioning, generous kitchen with dishwasher, a huge covered entertaining area and all bedrooms have built in robes. The home is situated on a large 735 sq mtr block with an oversized single garage with loads of storage and rear access for caravan/boat storage under the single carport.

**Price:** \$580,000-\$620,000



**Luke Wenban**

0418 165 979

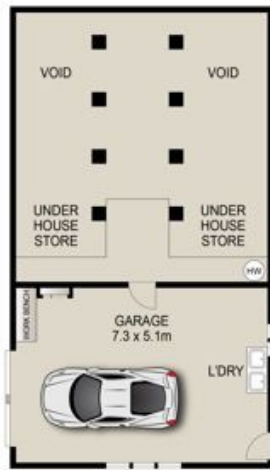

INT : 141m<sup>2</sup> EXT : 65m<sup>2</sup>  
 LAND SIZE : 770m<sup>2</sup>



0 1 2 3 4 5 SCALE METRES

Plans shown are for presentation purposes only and are not part of any legal document or title. They are subject to errors, omissions, inaccuracies and should not be used as a sole and accurate reference. Interested parties should make their own inquiries using independent sources.

# 1 Kintorie Crescent, Toormina