

2/33 Pepperman Road BOAMBEE EAST, NSW



"A Bargain 4 Bedroom Modern Home"

To find such a spacious home at such a great price, it is really worthy of your inspection! Featuring 4 spacious bedrooms, built ins, walk in robe & ensuite to main bedroom & fabulous pitched ceilings in the family room. The huge kitchen includes a dishwasher, walk in pantry and loads of bench space for the avid chef. Air conditioned, there is also a double lock up garage with internal & remote access PLUS a concrete slab for boat or caravan storage. The fully fenced level rear yard has plenty of room for a swimming pool. There are NO STRATA FEES on this property.

Price:

O/O \$360,000

Stone Real Estate -

Head Office

500
 Council provides this information under the requirements of the Government Information (Public Access) Regulation 2009 & the Environmental Planning & Assessment Regulation 2000. This information is for your review only & is subject to copyright. Council accepts no responsibility for the recipient's use of this information.

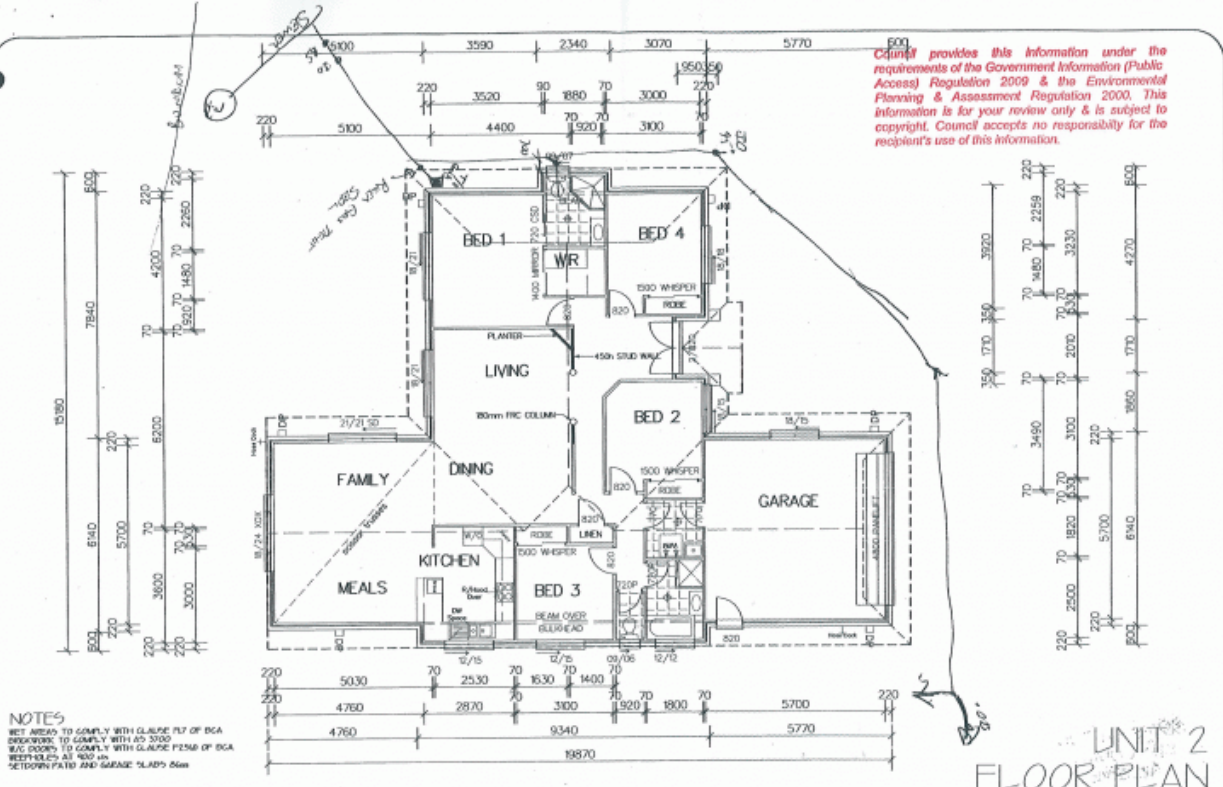

NOTES
 BEH AHEAD TO COMPLY WITH CLAUSE 157 OF BCA
 BRICKWORK TO COMPLY WITH AS 3700
 W/C ROOMS TO COMPLY WITH CLAUSE 158 OF BCA
 REEF FLOORS AS 1001-10
 SETDOWN PAVED AND GARAGE SLABS 20mm

UNIT 2
 FLOOR PLAN

This Plan is Copyright to CENTURY 21 New Homes



GOLD COAST OFFICE
 PHONE NO. 071 5534 1666
 FAX NO. 071 5534 7146
 BRISBANE OFFICE
 PHONE NO. 071 3660 1215
 FAX NO. 071 3660 0254

COPYRIGHT
 This is the property of CENTURY 21 New Homes and may not be used in whole or in part without written consent of any person infringing the copyright.

ELECTRICAL LEGEND
 ○ 6/0
 ● 6/0 600 AFL
 ▲ 6/0 600 AFL
 ○ 6/0 6/0
 ● 6/0 6/0 600 AFL
 ▲ 6/0 6/0 600 AFL
 □ 1V. OUTLET

No.	DATE	REVISION

PROPOSED BRICK-VENEER DWELLING
 AT : LOT 17 PEPPERMAN RD
 BOONDELL
 FOR : S & E VEZIC

DESIGN		SCALE		JOB No.		SHEET	
ISLANDER 22		1:100		99858		4	
MASTER	JOB	SCALE	JOB No.	SHEET			
DATE							