



14 Summerwood Way Beecroft, NSW 3 2 2

Torrens Title Duplex in Beecroft Primary and Cheltenham Girls Catchment

Peacefully nestled in a blissful Beecroft pocket, this duplex enjoys a private position at the rear of the complex and presents a rare opportunity to embrace a serene lifestyle. Boasting the natural advantage of a north-facing rear, its sunbathed, modern interiors fuse warmth and stylish design. It's in the Beecroft Public, Cheltenham Girls, and Pennant Hills High catchment.

Price: Auction
Council Rates: \$505.60 p/q
Water Rates: \$173.29 p/q



Kevin Dearlove
0403 338 302



Brian Kong
0435 333 383

14 Summerwood Way
Beecroft



FIRST FLOOR



GROUND FLOOR

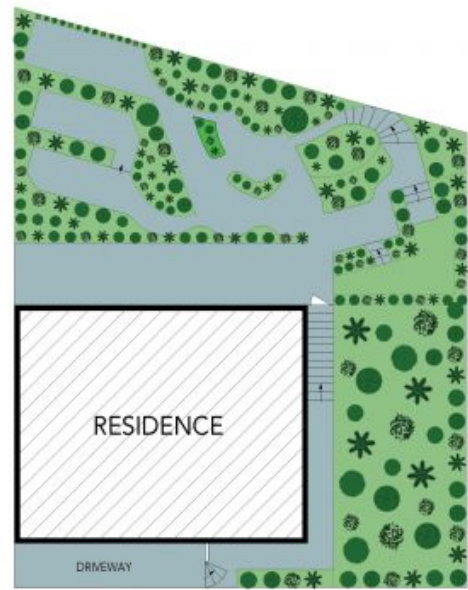

SITE PLAN



The site plan and floor plan are not to scale; measurements are indicative and in metres. Bushes and trees are placed for illustration purposes. Plans should not be relied on. Interested parties should make and rely on their own enquiries. All other information provided has been collected from reliable sources but cannot be guaranteed for accuracy.