

STONE



1/33-35 Keren Avenue Berkeley Vale, NSW



## Affordable Berkeley Vale Investment

**Price:** \$560,000  
**Council Rates:** \$1,110.00/year (approx)  
**Strata Rates:** \$750.00 p/q



**Volkan Akintetik**

0499 830 247



**Reece Caira**

0431 013 342

1-33-35 Keren Avenue  
Berkeley Vale

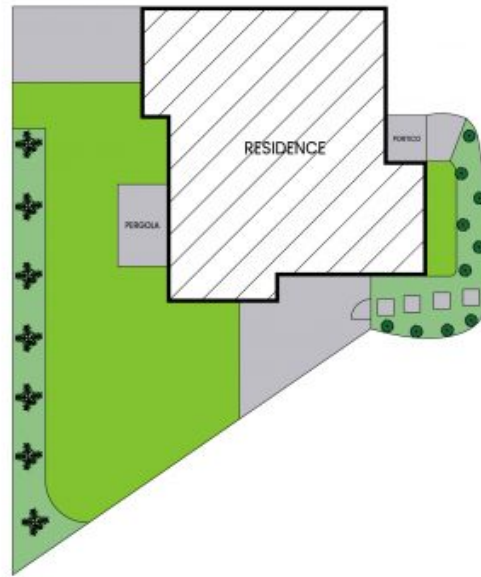

Internal Area: 102 sqm  
External Area: 6 sqm  
Garage Area: 19 sqm  
Total Area: 127 sqm

PLEASE NOTE: These Floor and Site Plans have been generated for marketing purposes and are to be used as a guide only. While all care is taken, no guarantee can be given in respect of accuracy, sizes and dimensions are approximate, actual may vary