



6 Elva Avenue Killara, NSW



Premier east side elegance captivates with walk to rail convenience.

This rare and sophisticated home offers the best of the North Shore, pairing a leafy north to rear setting with walk to rail convenience. Enjoy blissful privacy on 853sqm approx. of land, with handy rear access to Forsyth Street. Two substantial living and dining areas are enhanced by a custom granite kitchen and seamless connection to the outdoors for poolside entertaining wrapped in richly landscaped gardens. The main bedroom is a masterpiece of luxury perfect for revitalising after a long day. Walk to Killara or Gordon rail. In Killara High School zone.

Price:

Contact Agent



Matt Payne

0435 825 242



Ryan Woo

0410 884 680

6 Elva Avenue
Killara

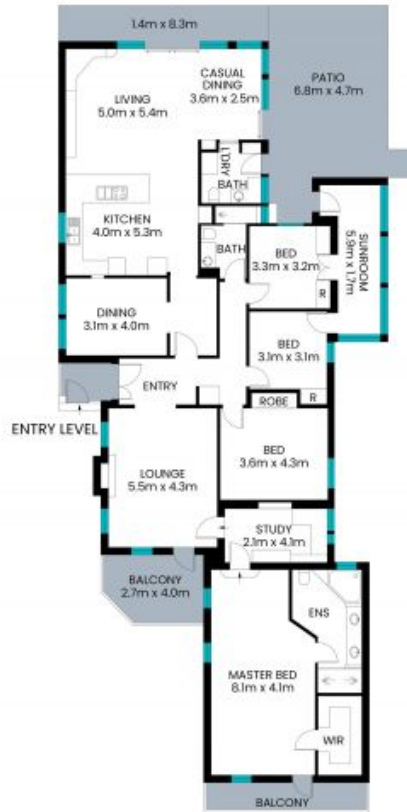

Internal area: 295m²
External area: 70m²
Total area (approx.): 365m²

The site plan and floor plan are not to scale; measurements are indicative and in meters. Bushes and trees are placed for illustration purposes. Plans should not be relied on. Interested parties should make and rely on their own enquiry. All other information provided has been collected from reliable sources but cannot be guaranteed for accuracy.