



91 Eastview Avenue North Ryde, NSW 3 2 2

### Tranquil Living In Desired Location

Surrounded by near new homes & set on a high side parcel of land with a wide 16.459m frontage, this family home provides an exceptional opportunity to move in, renovate, or build your dream home (STCA).

Located in the heart of North Ryde it is superbly convenient, close to transport, schools, Macquarie Centre, Top Ryde shopping center, university, business parks, shops, and easy access to surrounding quality suburbs.

With a naturally-lit aspect, you are spoilt being perfectly situated in the prestigious Kent Road Public School, Ryde Secondary College, and Epping Boy's High. With a lifestyle suitable for growing families, extended families, or the savvy investor allowing you to move in, renovate, or rebuild it's the perfect opportunity to make this house your home.

- Features:
- High side block of land on 543.8 sqm with 16.459m frontage appx

**Price:** Sold \$2,110,000  
**Council Rates:** \$395.00 p/q  
**Water Rates:** \$173.29 p/q



**James Sarzano**  
 0410 155 496



**Jason Segon**  
 0435 606 398



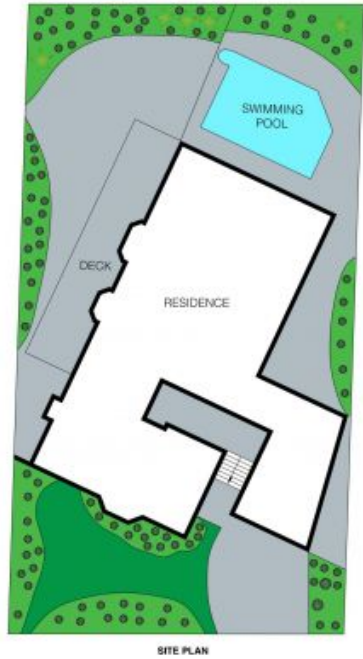

The floor plan is not to scale, measurements are indicative and in metres. External elements are not in position. Plans should not be relied on. Interested parties should make and rely on their own enquiries.

# 91 Eastview Avenue, North Ryde

