



1 Allandale Street Pelaw Main, NSW



### Quietly comfortable excellence

Presenting neatly towards a quiet Pelaw Main street, this pleasant three-bedroom home promises a tranquil, hassle-free lifestyle that any family would be glad to call their own. It is comfortably located close to Pelaw Main Public School, Kurri Kurri town centre, and a whole range of local parks and reserves.

Price: \$575,500



**Renee Bean-Wyper**

0403 325 076

1 Allandale Street  
Pelaw Main



Site Map

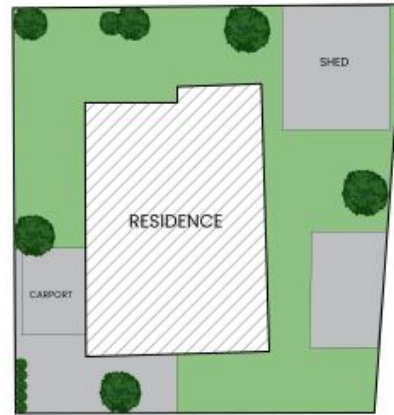

The site plan and floor plan are not to scale; measurements are indicative and in metres. Bushes and trees are placed for illustration purposes. Plans should not be relied on. Interested parties should make and rely on their own enquiries. All other information provided has been collected from reliable sources but cannot be guaranteed for accuracy.

