



19/2-6 Lydbrook Street Westmead, NSW



Split Level Apartment

Situated in a sought-after location, you'll enjoy easy access to a range of amenities and living within walking distance to both Wentworthville & Westmead Train Station and in close proximity to Westmead Hospital, schools, and local shops.

Price: \$540,000



Simar Gill

0410 312 242



Chris Kypreos

0432 354 445

19/2-6 Lydbrook Street
Westmead



BASEMENT

FIRST FLOOR



GROUND FLOOR



The floor plan is not to scale; measurements are indicative and in metres. All features included in this 3D plan are for inspiration purposes only. This is not an exact replica of the property or the position of exterior elements. Plans should not be relied on. Interested parties should make and rely on their own enquiries.

19/2-6 Lydbrook Street
Westmead

STONE

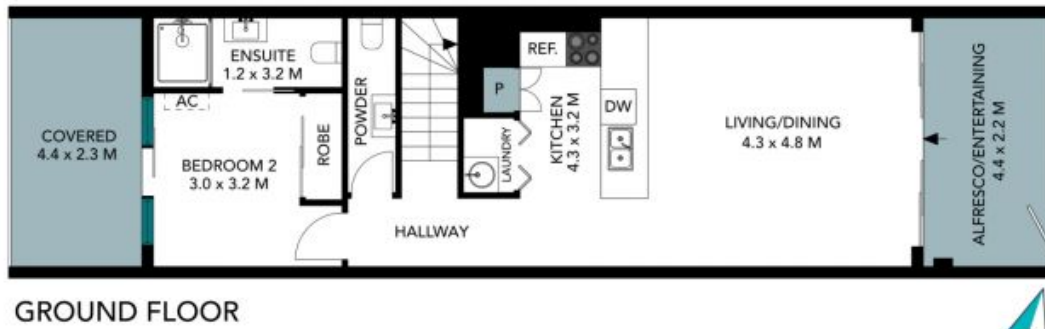
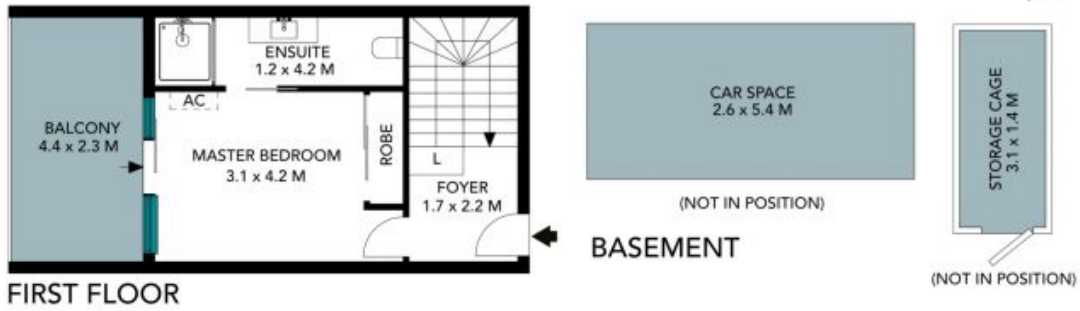

The floor plan is not to scale, measurements are indicative and in metres. Exterior elements are not in position. Plans should not be relied on, interested parties should make and rely on their own enquiries. All other information provided has been collected from reliable sources but cannot be guaranteed for accuracy.