

8 Mole Avenue Southport, QLD



Charming family home in the heart of Southport

Bathed in natural light & nestled on a 508 square metre block, this property is positioned perfectly only minutes from Southport State High as well as a quick trip to the water. You are within a short distance to public transport and all the key amenities including additional quality educational options, child care facilities and the Queen Street Village Shopping Centre. With such a central location, the array of shopping and dining possibilities will keep you busy all year long!

Price: \$775.00 pw

Available Date: 17/11/2023



Georgia Macdonald

0402 883 995

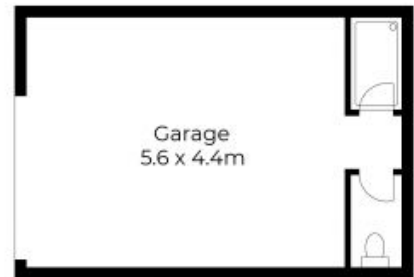

Floor plans and site plans are for illustrative purposes only. They are not part of any legal document or title and are subject to errors, omission, and inaccuracies. Whilst every attempt has been made to ensure the accuracy of this plan, measurements of doors, windows, rooms, cupboards etc are approximate only.

APPROXIMATE AREA
 LIVING AREA : 124 m²
 TOTAL AREA : 155 m²