



4 Albatross Road Berkeley Vale, NSW

4

2

2

### Coastal paradise!

Step into luxury with this stunning lakeside residence located in the sought-after suburb of Berkeley Vale. Ideal for families seeking ample space, this home features four bedrooms plus a separate office, two living areas adorned with front and rear balconies, and a seriously impressive outdoor entertaining space that overlooks a level backyard housing a glistening in-ground swimming pool.

Price:

Contact Agent



**Volkan Akintetik**

0499 830 247



**Reece Caira**

0431 013 342

# 4 Albatross Road Berkeley Vale

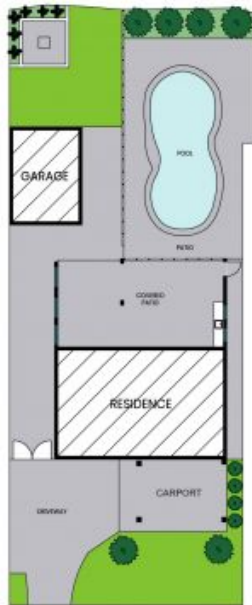

Site Plan

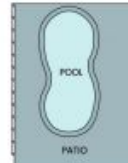

Floor One



Floor Two

Internal Area: 179 sqm  
 External Area: 129 sqm  
 Garage Area: 23 sqm  
 Total Area: 331 sqm

PLEASE NOTE: These Floor and Site Plans have been generated for marketing purposes and are to be used as a guide only. While all care is taken, no guarantee can be given in respect of accuracy, sizes and dimensions are approximate, actual may vary