



107c/80 Waterloo Road Macquarie Park, NSW

2  2  1 

Stylish apartment in top location

Located on level 1 this executive apartment is situated in the heart of Macquarie Park with everything at your doorstep. Designed by the award-winning architectural studio of DKO, this 2-bedroom apartment has good space allocation and fine interior details.

Price: \$830 per week

Available Date: 10/01/2024

Stone Beecroft | Castle

02 8866 1500

Hill | Epping



PARKONE
SYDNEY

C107 C308
C508 C608
 C1008

2 BED

Internal:	78m ²
External:	10m ²
Total:	88m ²

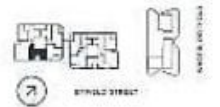

ENTER APARTMENT