



3/153 Cresthaven Avenue Bateau Bay, NSW



Spacious Townhouse In Convenient Location

Welcome to a charming and spacious double-story townhouse nestled in a fantastic complex. Perfectly situated near vibrant shopping destinations and the serene allure of the beach.

This contemporary home boasts three generously-sized bedrooms, each providing a private haven for relaxation and personal space. The master suite, adorned with large windows, invites natural light to illuminate the room, creating an airy and inviting atmosphere. With an ensuite bathroom and double built in robes, this retreat offers convenience and luxury. The remaining two bedrooms, equally well-appointed, one with built in robe and the other with a modern ensuite, both providing comfort and functionality.

Price: \$750,000 - \$790,000



Shanti Santhou

0437787221

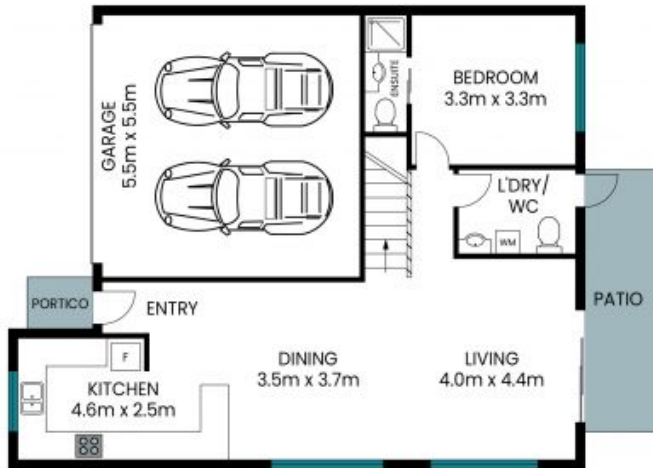

Lower Level

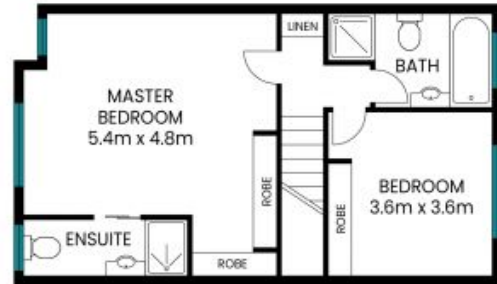

Upper Level

Internal Area: 124 sqm
External Area: 11 sqm
Garage Area: 31 sqm
Total Area: 166 sqm

PLEASE NOTE: These Floor and Site Plans have been generated for marketing purposes and are to be used as a guide only. While all care is taken, no guarantee can be given in respect of accuracy, sizes and dimensions are approximate, actual may vary.