



2/24 Murray Street Booker Bay, NSW 3 2 2

Dream lifestyle townhouse

++ Private inspections available by appointment++

Stone Ettalong Beach would like to introduce 2/24 Murray Street Booker Bay.

This elegantly simple home is positioned at the rear of the complex with only two on the block. Ensuring ample space and privacy.

Bright and spacious with an abundance of natural light, the ground level features the master bedroom suite with bespoke cabinetry and track lighting, a modern chef's kitchen overlooking the indoor/outdoor dining areas, and resort style courtyard.

Situated in a family friendly neighbourhood, and only a leisurely 500m stroll to the iconic Ettalong foreshore, and Ettalong Galleria featuring restaurants, cafes, and a boutique cinema complex.

Features include:

...

Price: \$1,200,000
Council Rates: \$1,348.54/year (approx)
Water Rates: \$912.89/year (approx)



Joshua Young
0431 324 498



Joshua Young
0431 324 498

2/24 Murray Street
Booker Bay

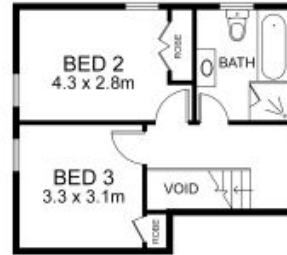

The site plan and floor plan are not to scale; measurement are indicative in meters. Bushes and trees are placed for illustration purposes. Plans should not be relied on. Interested parties should make and rely on their own inquiries. All other information provided has been collected from reliable sources but cannot be guaranteed for accuracy.