

7 King Road Hornsby, NSW

3 1 3

### Subdividable block

Don't miss this rare opportunity to build on a subdividable, 1,263.4sqm block appealing to all investors, builders & developers. Positioned in the heart of Hornsby, its minutes to Hornsby Westfield, Hornsby Hospital, train stations, parks, Asquith Girls and Asquith Boys High School, St Patrick's Catholic School and Asquith Public School.

Features;

- 6 minute drive from the M1 giving fast access to Sydney, the Central Coast, or Western suburbs
- 4 minute drive to Hornsby Westfield, restaurants & cafes
- 4 minute drive to Hornsby Train Station
- 3 minute drive to Hornsby Hospital
- Asquith Public School, Asquith Girls and Asquith Boys High School

Land 1,263.4 sqm with approval in place for subdivision into 2 lots.

"We have obtained all information in this document from sources we believe to be reliable;..."

**Inspect:** Saturday, 11th May 2024 9:00 - 9:30

**Price:** \$2,200,000



**Steve Noakes**

0431 620 422



**Adam Noakes**

0450 753 268

7 King Road,  
Hornsby

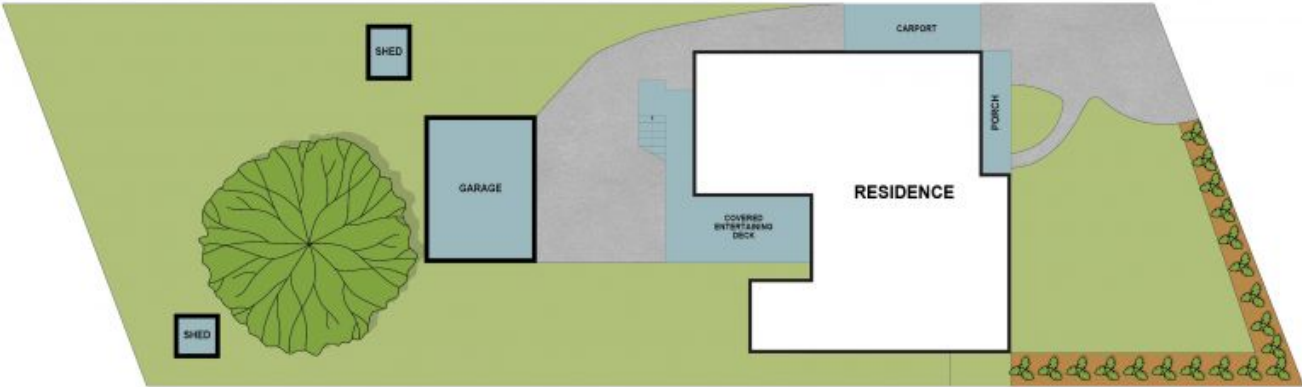

The floor plan is not to scale, measurements are indicative and in metres. Exterior elements are not in position. Plans should not be relied on interested parties should make and rely on their own enquiries. All other information provided has been collected from reliable sources but cannot be guaranteed for accuracy.