

253 Geoffrey Road Chittaway Point, NSW

3

2

2

Lakefront living entry level

Occupying an unparalleled position on Tuggerah Lake, this lakefront reserve home showcases an enchanting backdrop of lake views and combines style, flair and waterfront living in a suburb known for its privacy and relaxed lifestyle. Providing for your next family home, retirement option or holiday destination, this three bedroom home offers a seamless floor plan with fantastically appointed open plan living and dining areas and private entertaining deck overlooking the stunning lake perfect for lazy afternoons or long weekends with family and friends. Air conditioning and raked ceilings ensuring comfort year round. Plenty of storage and parking with a tandem carport and garage with power on a generous 841sqm block (approx.). Centrally located to major shopping centres, beaches, schools, trains and the M1 motorway, this is the ideal spot for a local or a commuter. This could be your once in a lifetime opportunity to purchase into this prestigious suburb and start living the dream!

Price: \$815,000



Abdullah Choudhari

0401 977 187



Jameel Hasan

0468 645 844

253 Geoffrey Road
Chittaway Point



Site Plan

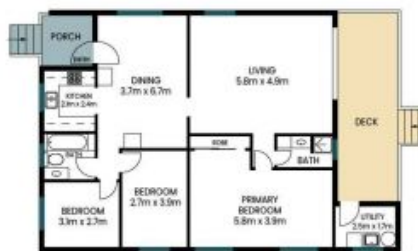

Internal Area: 111 sqm
External Area: 23 sqm
Total Area: 134 sqm

PLEASE NOTE: These Floor and Site Plans have been generated for marketing purposes and are to be used as a guide only. While all care is taken, no guarantee can be given in respect of accuracy, sizes and dimensions are approximate, actual may vary