



138 Beecroft Road Beecroft, NSW

4 2 2

Period elegance on 1,834sqm with potential to Sub-Divide (STCA)

A beautiful home of stately significance since c1928, this magnificent family residence offers a step into a prized bygone era with current-day comforts, for a superb fusion of past and present on 1,834sqm land. Characterised by grand plaster-detailed ceilings and internal proportions, original hardwood features, and mature gardens lined with established natives and exotic trees, its address is equally attractive - within a 1km approx. stroll to Beecroft village shops, station and cafes.

- Privately gated frontage with trimmed gardens and tessellated verandah entry
- Central hallway introduces an expansive formal lounge with ornate fireplace
- Premium marble kitchen equipped with gas cooktop, Smeg & Bosch appliances
- Casual meals area enjoying rear garden views, classic period family bathroom
- Four grandiose beds, front featuring a bay window seat & original leadlights
- Master has extensive built-ins, ensuite and a bay window overlooking the pool
- Solar hot water system, external laundry with toilet, cubby and a garden shed
- Elegant undercover alfresco deck, sprawling lawns abutting an in-ground pool

Price: Sold prior to auction
Council Rates: \$703.80 p/q
Water Rates: \$173.29 p/q



Kevin Dearlove

0403 338 302



Jennifer Zhang

0424 377 662

138 Beecroft Road

Beecroft

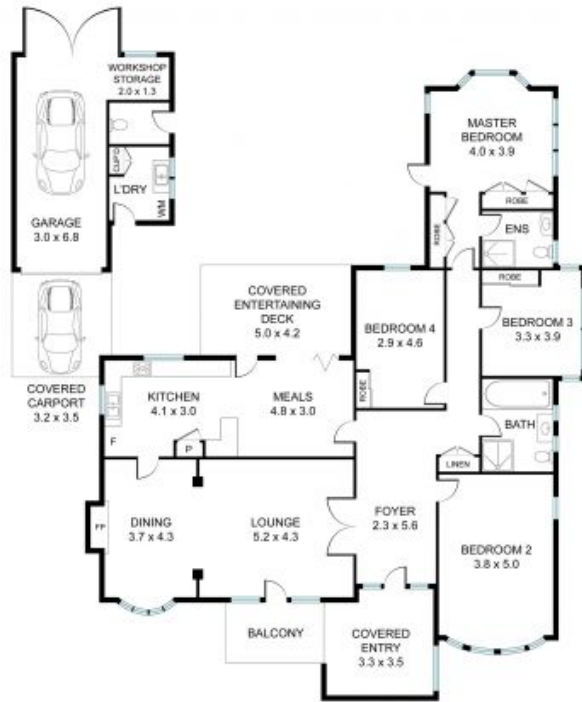

SITEPLAN
(NOT TO SCALE)

The site plan and floor plan are not to scale; measurements are indicative and in metres. Bushes and trees are placed for illustration purposes. Plans should not be relied on. Interested parties should make and rely on their own enquiries. All other information provided has been collected from reliable sources but cannot be guaranteed for accuracy.

