



16/261 Condamine Street Manly Vale, NSW



Sold by Eddy Piddington 0414 333 907

Set at the rear of the secure 'Verde' contemporary security building, this apartment offers privacy with stunning quality finishes. The open plan living zone connects to a private covered terrace, perfect for relaxed entertaining. It offers the ease of lift access and secure basement parking, plus footstep access to restaurants, cafes, supermarkets and B-Line buses, plus minutes to surf beaches.

- Generous open plan living area flooded with natural light extends outdoors
- Streamlined kitchen with stone benchtops, stainless steel Smeg gas appliances
- Private terrace, with ample space for alfresco dining or the perfect spot to unwind
- Spacious bedroom with mirrored built-ins, ideally placed away from the social spaces

- Chic bathroom with marble feature tiles, New York style laundry with built-in cabinetry ideal for storage
- Reverse cycle air conditioning, gas heating outlet, high ceilings
- Security complex with lift, video intercom, basement parking with storage cage

Council rates: \$403pq approx.

Price:

Price Guide: \$650,000



Eddy Piddington

0414 333 907



Lachlan Phillips

0481 007 320

16/261 Condamine Street
Manly Vale

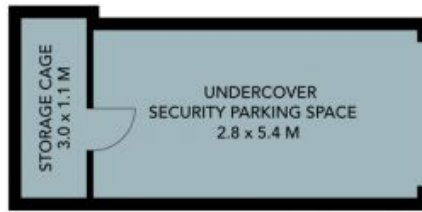

(NOT IN POSITION)

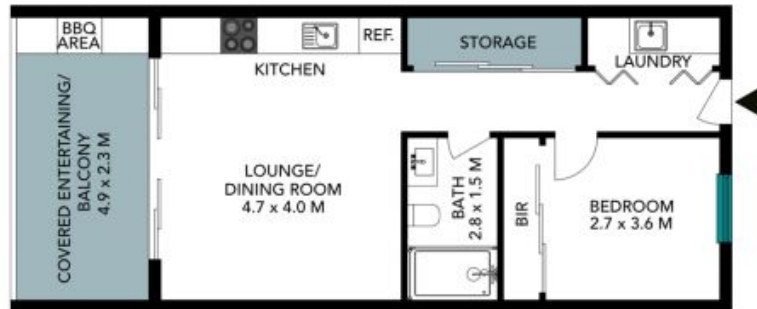

The floor plan is not to scale, measurements are indicative and in metres. Exterior elements are not in position. Plans should not be relied on, interested parties should make and rely on their own enquiries. All other information provided has been collected from reliable sources but cannot be guaranteed for accuracy.

16/261 Condamine Street
Manly Vale



The floor plan is not to scale, measurements are indicative and in metres. All features included in this 3D plan are for inspiration purposes only. This is not an exact replica of the property or the position of exterior elements. Plans should not be relied on. Interested parties should make and rely on their own enquiries.