



52 Woodview Avenue Lisarow, NSW

6

3

2

Luxurious living in Lisarow

Indulge in the epitome of luxurious living with this impeccably crafted family residence. Beyond its picturesque exterior, framed by meticulously manicured grounds, lies a home that seamlessly blends classic quality with a distinctive European elegance, offering unparalleled features that will leave you in awe.

Be impressed by the high ceilings as you step inside, creating an open and spacious ambiance throughout. The thoughtfully designed layout effortlessly combines elegance and functionality, catering to both entertaining and everyday living.

Discover six generously sized bedrooms, each designed to provide private retreats. Attention to detail ensures comfort and style blend seamlessly, making this space a haven for every family member.

...

Private and in an incredibly convenient location. Approximately 4 Minutes to Lisarow Plaza, 3 Minute drive to Lisarow Train Station, 8 minutes to the M1 Motorway, 2 minutes to Lisarow Public School, 4 minutes to Lisarow High School and 18 minutes from a range of beautif...

Price:

Contact Agent



Isaac Scarcella

0423497876

52 Woodview Avenue
Lisarow



Floor 1

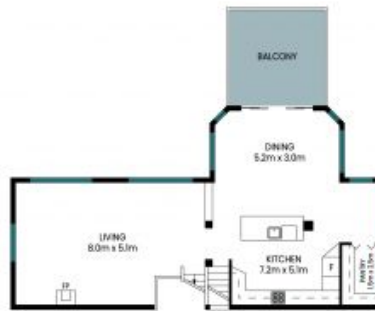

Floor 3



Floor 2

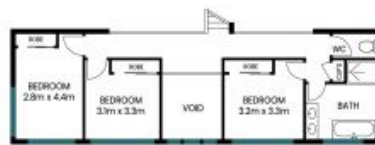

Floor 4



Site Plan

Internal Area: 295 sqm
External Area: 114 sqm
Garage Area: 36 sqm
Total Area: 445 sqm

PLEASE NOTE: These Floor and Site Plans have been generated for marketing purposes and are to be used as a guide only. While all care is taken, no guarantee can be given in respect of accuracy, sizes and dimensions are approximate, actual may vary