

40 Mossman Parade Waterford, QLD

4

2

2

## GREAT SPLIT LEVEL HOME

Set in the beautiful Woodlands estate is this split level home.

Featuring a carpeted lounge on entry, which steps up to the spacious kitchen with dishwasher, large pantry and ample cupboards, this modern and functional kitchen overlooks the light filled, spacious tiled open plan meals/family room which comes with the added comfort of a split system air conditioning.

Comprising of 4 bedrooms, all have been fitted with built-in robes, the master bedroom features an ensuite and walk-in robe.

There is a cosy and private backyard very little yard maintenance. Free up your Weekend! Complete with a double remote lock-up garage with internal access.

All within walking distance to parks and local shops, and all the amenities that the Woodlands Estate have to offer.

### FEATURES

- 4 Bedrooms
- 2 Bathrooms
- Double lock up garage
- Low maintenance living

**Price:** \$550 per week

**Bond:** \$2,200

**Available Date:** 09/02/2024



**Sheryl Hay**

0415 695 010

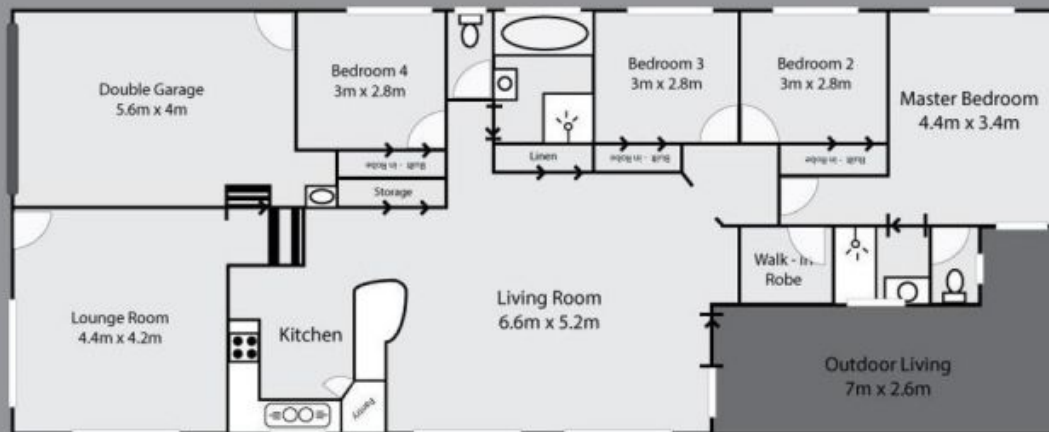

40 Mossman Parade, Waterford