



10 George Road Wilberforce, NSW

2 

1 

First home buyers, investors & tradies

Nestled in the heart of Wilberforce, sprawling across an 865sqm block, just seconds from Wilberforce Public School, Wilberforce Shopping Village and 10 minutes from Windsor. 10 George Road, Wilberforce makes a perfect first home, ideal renovation project or a smart investment.

Price: \$820,000



Adam Buchert

0488 717 184

10 GEORGE ROAD, WILBERFORCE

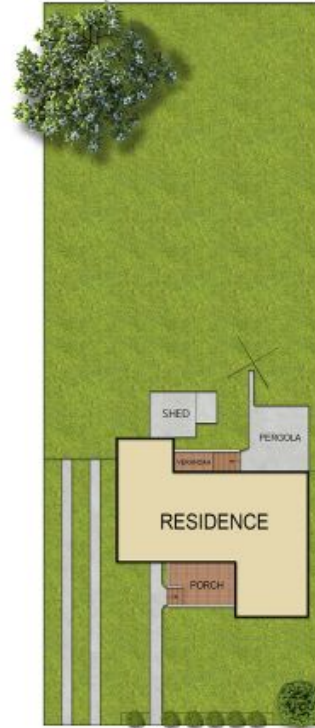

SITE PLAN
(NOT TO SCALE)



DISCLAIMER DIMENSIONS ARE APPROXIMATE AND SHOULD BE USED AS A GUIDE THEY ARE NOT TO SCALE AND NO LIABILITY BE ACCEPTED