

61/25 Northmarque Street Carseldine, QLD

4 2 2

Pet Friendly and Parkside

The ideal starter, downsizer or the savvy investor! Just seconds to parkland, cafes, transport and more, this immaculately presented townhouse boasts an abundance of natural light with some of the best private outdoor living you will find.

- North/South facing aspect
- NBN Fibre to the Premise
- Goodwe solar system
- Rheem hotwater system
- Fully fenced courtyard
- Secure garage plus carport
- Large water tank
- Strata Rates \$2,059.35 pq approx.

Price: For Sale Now



Tristan Rowland

0411 572 970



Kate Veal

0455 333 306

INTERNAL 145 SQM
EXTERNAL 58 SQM
TOTAL 203 SQM

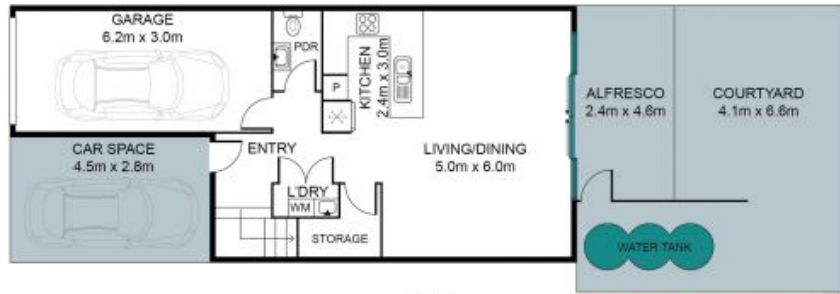
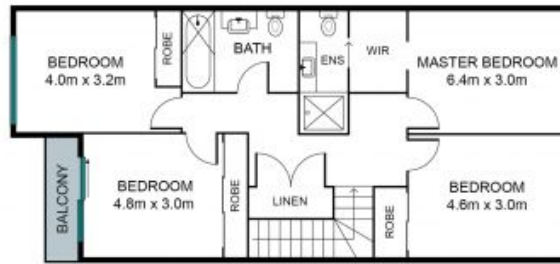

The site plan and floor plan are not to scale, measurements are indicative and in metres. Bushes and trees are placed for illustration purposes. Plans should not be relied on, interested parties should make and rely on their own enquiries.

61/25 Northmarque Street, Carseldine

Stoneaspley.com.au

