



329 West Portland Road Sackville, NSW

3

2

3

### Immaculately Presented Home On A 1,100m2 Block with Side Access

This immaculately presented home, boasting rural views towards the Hawkesbury River, presents the perfect haven for families or anyone in search of a peaceful lifestyle in a serene location and includes a right of access to the Hawkesbury River, located directly opposite the property.

Nestled amongst beautiful established gardens the spacious well-maintained home is perfectly positioned on a massive 1,100m2 parcel with drivable side access, perfect for buyers in need of secure off street parking space for the boat, caravan, trailer or other vehicles with a large three car garage with automatic doors located at the rear of the block.

Just 10 minutes to Wilberforce and 20 minutes to Windsor the property offers something for everyone.

- Three good size bedrooms, all with built in robes and master with ensuite
- Expansive covered entertaining area
- Meticulously maintained gardens with the front and rear yards securely fenced, safe for...

Price:

Property Under Contract



**Rhys Coles**

0406 704 040

329 WEST PORTLAND ROAD, SACKVILLE

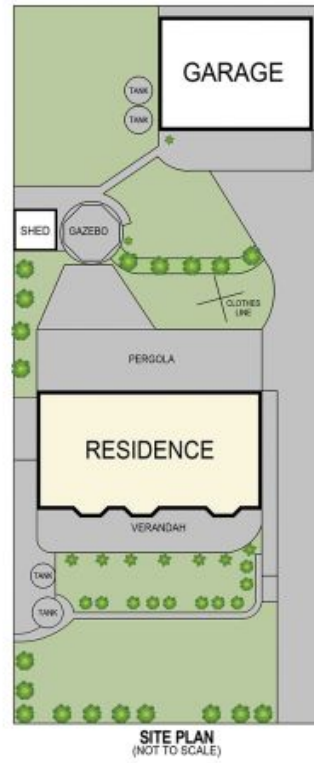
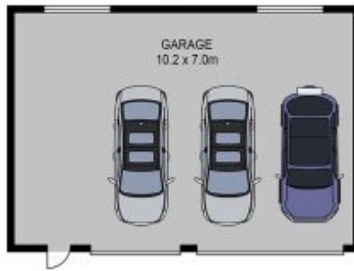

DISCLAIMER DIMENSIONS ARE APPROXIMATE AND SHOULD BE USED AS A GUIDE THEY ARE NOT TO SCALE AND NO LIABILITY BE ACCEPTED