



2 Kensington Place Mardi, NSW

4

2

2

Resort-style family living! TLC needed.

This 4 bedroom home is positioned in the tightly-held "Kensington Place Estate" in Mardi. With access to top tier amenities including the sparkling inground pool, picturesque parklands, BBQ area and clubhouse facilities. This is easy family living at its finest!

Price: \$795,000



Alyce Lewis

0423 950 626

2 Kensington Place Mardi

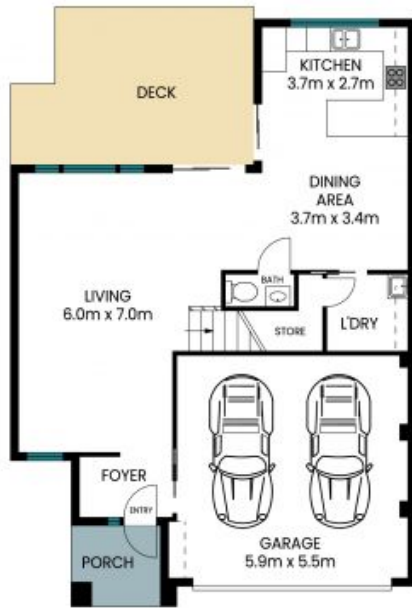

Ground Floor



First Floor

Internal Area: 163 sqm
External Area: 26 sqm
Garage Area: 32 sqm
Total Area: 221 sqm

PLEASE NOTE: These Floor and Site Plans have been generated for marketing purposes and are to be used as a guide only. While all care is taken, no guarantee can be given in respect of accuracy, sizes and dimensions are approximate, actual may vary