



132/8 Koorala Street Manly Vale, NSW 2  2  2 

### 5-star resort-style living in key central location

Set yourself up for a lifestyle of luxury and convenience in this exceptionally bright and spacious executive apartment. Nestled amid the park-like grounds of the exclusive 'Peninsula' security building with a heated indoor/outdoor pool, spa and gym, its idyllic setting is within footsteps of supermarkets and B-line city buses and only minutes from Manly Beach.

Price:

Contact Agent



**Eddy Piddington**

0414 333 907



**Lachlan Phillips**

0481 007 320

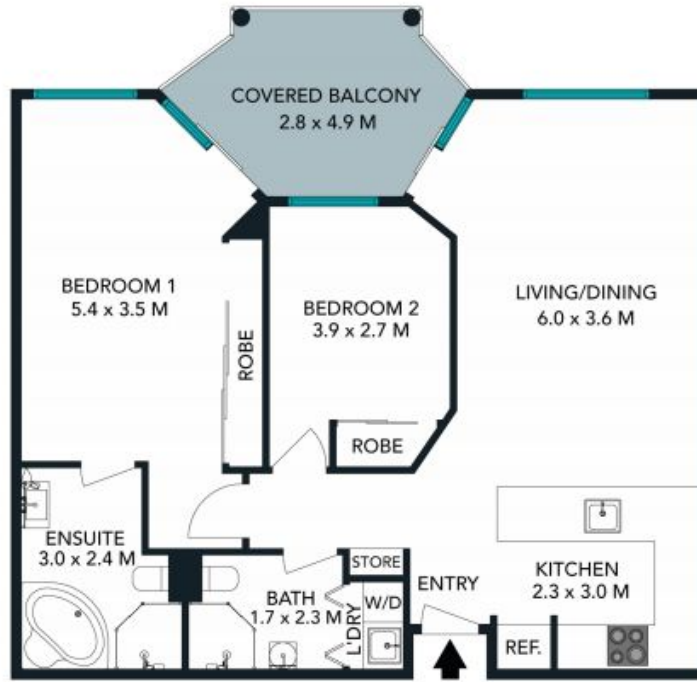

The floor plan is not to scale; measurements are indicative and in metres. Exterior elements are not in position. Plans should not be relied on. Interested parties should make and rely on their own enquiries.

132/8 Koorala Street, Manly Vale  
stonerealestate.com.au

Produced by DIAKRIT



The floor plan is not to scale; measurements are indicative and in metres. All features included in this 3D plan are for inspiration purposes only. This is not an exact replica of the property or the position of exterior elements. Plans should not be relied on. Interested parties should make and rely on their own enquiries.

132/8 Koorala Street, Manly Vale  
stonerealestate.com.au

Produced by DIAKRIT