

43 Albert Road Beecroft, NSW



Flair and functionality in the Beecroft Public zone

A peaceful haven that celebrates modern excellence, with thoughtful regard for sustainability, this cleverly designed split-level home accommodates multi-generational or changing family needs with effortless ease. The spaciousness of its 777.8sqm block carries on throughout its vast open interiors, which offer flexibility for everything from guest or dual living, to home business or large-scale entertaining. Built by its current owners and cherished for over a decade, it's a masterclass in functional space - with perfect positioning in the sought-after Beecroft Primary and Cheltenham Girls catchments.

Price: Contact Agent
Council Rates: \$680.68 p/q
Water Rates: \$171.41 p/q



Jeff Jianfu Luo

0425 286 668



Kevin Dearlove

0403 338 302

43 Albert Road Beecroft



ENTRY LEVEL

GROUND LEVEL

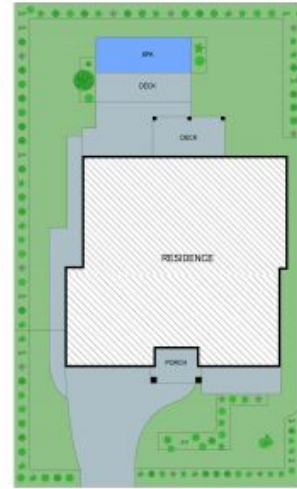

SITE PLAN
(Not to Scale)

The site plan and floor plan are not to scale; measurements are indicative and in metres. Bushes and trees are placed for illustration purposes. Plans should not be relied on. Interested parties should make and rely on their own enquiries. All other information provided has been collected from reliable sources but cannot be guaranteed for accuracy.

