

6A Waratah Street Arncliffe, NSW

4

2

2

### Near-new freestanding palace with commanding views

Breathtaking views crown this luxe contemporary palace, with each impressive level gazing across rooftops to the depths of Botany Bay.

A haven of crisp white angles, extensive glazing and heavenly natural light, this abode streams from sprawling open-plan living out to an entertainment terrace, lawn and gorgeous hedge-trimmed pool.

The opulence continues upstairs, between a sundrenched sitting room or office, four bedrooms and immense master suite complete with parents' retreat. Ascend one more level to a roof terrace, where the bird's eye views are truly majestic.

Solid brick and concrete slab freestanding residence across three levels, including a rooftop terrace

- Gun barrel views to the bay and Port Botany

...

Price:

SOLD | CONTACT AGENT



**Sam Abbas**

0406 750 075



**Tanios Azzi**

0412 772 369



6A Waratah Street  
Arncliffe



Site Plan



First Floor

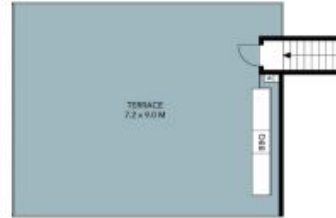

Roof



Ground Floor



The site plan and floor plan are not to scale; measurements are indicative and in metres. Bushes and trees are placed for illustration purposes. Plans should not be relied on. Interested parties should make and rely on their own enquiries. All other information provided has been collected from reliable sources but cannot be guaranteed for accuracy.

6A Waratah Street  
Arncliffe

STONE



First Floor



Roof



Ground Floor



The floor plan is not to scale; measurements are indicative and in metres. All features included in this 3D plan are for inspiration purposes only. This is not an exact replica of the property or the position of exterior elements. Plans should not be relied on. Interested parties should make and rely on their own enquiries.