



59a Ingham Avenue Five Dock, NSW

5

1

6

4

## A stunning display of luxurious family living

From its spectacularly crafted frontage through to its breathtaking interior, this impressive home provides a picture-perfect family atmosphere. Multiple living areas are laid out over three light filled levels, with high-quality finishes and a range of additional features. It's just moments from the water's edge, the Bay Run and local cafes, while offering easy access to the future Metro station.

- Multiple quiet living areas over different levels with plenty of natural lighting
- Enhanced ambiance provided by sweeping ceilings, herringbone timber floors
- Effortless outdoor flow to intimate alfresco entertaining area with barbecue
- Five generous bedrooms with built-in/walk-in wardrobes, ensuites and balconies
- Kitchen with thick marble stone-top benches, butlers' pantry, Miele appliances
- Stylish bathrooms boast floor-to-ceiling tiling, feature rolling shower doors
- Expansive underground garage with Tesla charging and secondary living area
- Short walk to local parks and shopping options, eateries and public transport

Price:

For Sale: \$4,100,000



**Joseph Tropiano**

0401 002 211



**Irma Rinaudo**

0426 240 502

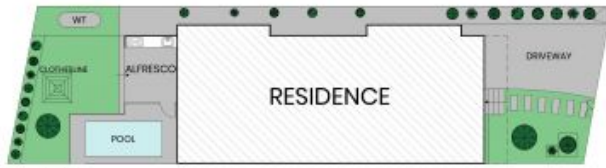

Site Plan



First Floor

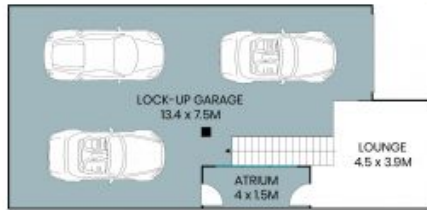

Lower Ground Floor



Ground Floor

Internal Living: 324sqm  
 External Living: 182sqm  
 Total Living Area: 269sqm



The site plan and floor plan are not to scale; measurements are indicative and in metres. Bushes and trees are placed for illustration purposes. Plans should not be relied on. Interested parties should make and rely on their own enquiries. All other information provided has been collected from reliable sources but cannot be guaranteed for accuracy.



59A Ingham Avenue  
Five Dock



First Floor



Lower Ground Floor



Ground Floor



The floor plan is not to scale; measurements are indicative and in metres. All features included in this 3D plan are for inspiration purposes only. This is not an exact replica of the property or the position of exterior elements. Plans should not be relied on. Interested parties should make and rely on their own enquiries.