

62/23 Regent Honeyeater Grove North Kellyville, NSW



Luxury living

Oversized executive style residence has premium finishes & is superbly positioned on the 3rd level of the most desirable complex. A large & versatile floor plan 142sqm plus balcony overlooking parkland reserve. Spacious living areas plus media zone and separate study!

- A feel of space greets you on entry with an open plan & natural light
- Chic designer kitchen with European appliances, gas cooktop & stone bench tops
- Extensive storage, step in linen cupboard & separate study
- Ducted, zoned air-conditioning & security intercom
- Entertainers balcony with unobstructed bush views in an ideal corner location
- Two car spaces & lockup storage cage in the secure underground car park
- The complex has manicured grounds with sparkling in-ground pool & borders a reserve

*Embedded network

Disclaimer: All information contained herewith, including but not limited to the general p...

Price: \$680 Per Week

Bond: \$2,720

Available Date: 15/03/2024



Ashleigh Toole

02 8893 2222



James Xu

02 8866 1500



GROUND FLOOR

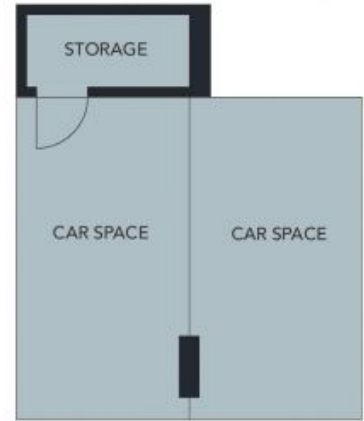

BASEMENT



Produced by DIAKRIT



GROUND FLOOR



BASEMENT