



5 Ashling Way Oxenford, QLD

4 2 2

### Immaculate Family Home in the Tranquil 'Saltwater Estate'

Price: \$1,151,800

Nestled in a tranquil cul-de-sac within the 'Saltwater Estate,' this residence enjoys a serene setting with a reserve just beyond the back fence. Situated on a 632sqm block, this family home is certain to leave a lasting impression. The open-plan living and dining areas effortlessly extend to the alfresco space and pool, creating a seamless and private atmosphere.

Features include:

- Immaculate single-level residence featuring 4 bedrooms, 2 bathrooms, and a 2-car garage
- Nestled in a private setting, the property backs onto a tranquil nature reserve
- Seamless flow from open plan living and dining areas to the outdoors
- Recently renovated chef's kitchen boasting a Caesar Stone island benchtop and a 900ml gas cooker with an electric oven
- Master bedroom with ensuite and built-in wardrobes
- Separate study, perfect for working from home



Sean Byfield

0438 061 979





- LEGEND**
- 1. Driveway Parking | 2. Entry Porch
  - 3. Side Gate Access | 4. Entertaining Patio
  - 5. Swimming Pool | 6. Water Tank
  - 7. Garden Shed (1.6 x 0.8)

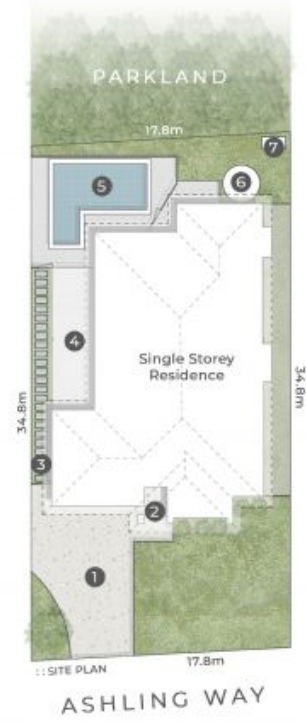

**STONE**

5 Ashling Way  
OXENFORD

632m<sup>2</sup>

4 Bed + Media  
+ Study

2 Bath

2 Car + Off-Street

Internal 243m<sup>2</sup>

Covered Patio  
& Porch 32m<sup>2</sup>

Total 275m<sup>2</sup>

**pdc.**

This is not a legal document therefore all measurements and information provided is subject to survey. No permission is given to use or alter this floor plan without the consent of Five Design Concepts. The overall presentation, style, layout, imagery, font, background, colours and nomenclature has been originally created by PDC and is subject to strict copyright. No warranty is given of building design. Find out more at [puredesignconcepts.com.au](http://puredesignconcepts.com.au)