



7 Strep Place McDowall, QLD

4 

2 

2 

### Immaculate lowset home

Located in the sought after Paramount Estate, investors, downsizers or first home buyers look no further, this lowset gem is ready & waiting for you. This single level family home is in a quiet & peaceful cul-de-sac, yet only less than 1 minute from parkland & just 10 minutes from Westfield Chermside. If lifestyle, location & convenience is what your after here it is!!

- Private Level 714sqm block with amazing outdoor living
- 3m high Cathedral style ceiling in main living
- Multiple living areas to suit the whole family
- Security screens & New carpets throughout
- Private outdoor entertaining area
- Fully fenced, pet friendly yard
- Hybrid Fibre Coaxial (HFC) NBN connection
- McDowall State School catchment

This home offers:

**Price:**

Offers over \$1,130,000



**John Bradley**

0410 454 718

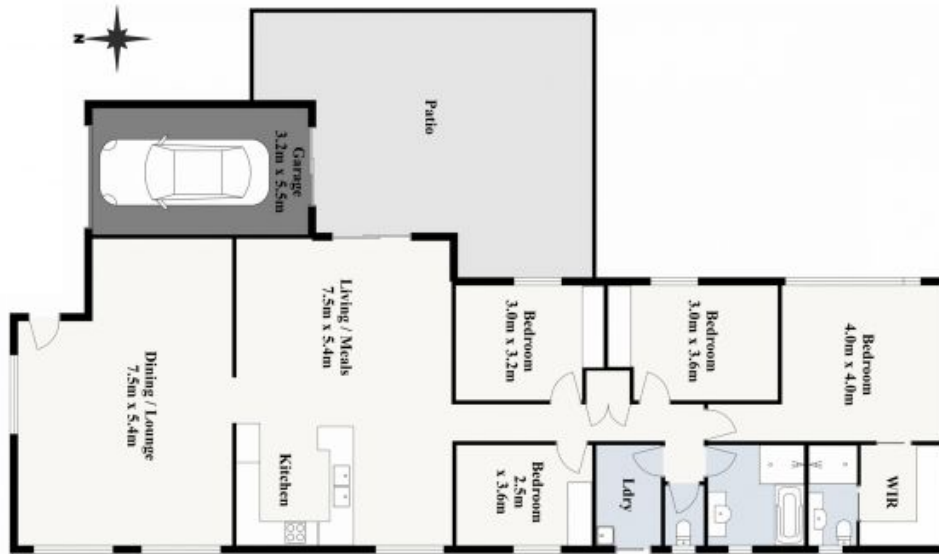

The site plan and floorplan are not to scale, measurements are indicative and in metres. Bushes and trees are placed for illustration purposes. Plans should not be relied on. Interested parties should make and rely on their own enquiries.

## 7 Strep Place, McDowall

[stonespley.com.au](http://stonespley.com.au)